

plaza
REIT

OPEN UNITS /
DISPONIBILITÉS

New / Nouveau Brunswick		
Dieppe Boulevard Plaza	Dieppe	15,368 sf/pc
Petitcodiac Plaza	Dieppe	24,757 sf/pc
Northumberland Square	Miramichi	21,740 sf/pc
Oromocto Plaza	Oromocto	8,326 sf/pc
Fairville Blvd Plaza	Saint John	10,060 sf/pc
Lansdowne Plaza	Saint John	8,071 sf/pc
Gateway Mall	Sussex	2,485 sf/pc
Newfoundland/Terre-Neuve		
The Village Shopping Centre	St John's	+/-97,000 sf/pc
The Shoppes at Galway	St John's	2,450 sf/pc
The Shoppes at Galway FD*	St John's	+/-104,000 sf/pc
Kenmount Road Plaza	St-John's	2,335 sf/pc
Ontario		
1000 Islands Plaza	Brockville	6,400+ sf/pc
Eastcourt Plaza	Cornwall	19,191 sf/pc
Timiskaming Plaza	New-Liskeard	FD – À Venir
Northern Avenue Plaza	Sault Ste Marie	3,474 sf/pc
Niagara St & Quaker Rd	Welland	24,282 sf/pc

Nova Scotia/Nouvelle Écosse		
Commercial Street Plaza	New Minas	4,000 sf/pc
Granite Drive Plaza	New Minas	1,829 sf/pc
Pleasant Street Plaza	Yarmouth	5,107 sf/pc
Chain Lake Drive	Halifax	6,945 sf/pc

PEI / IPE		
Buchanan Street Plaza	Charlottetown	34,474 sf/pc

Québec		
Plaza Charles-A-Cadieux	Lévis	1,815 sf/pc
5865-5875 Rue des Arpents	Lévis	1,650 sf/pc
Plaza Boulevard Royal	Shawinigan	13,625 sf/pc
Les galeries Montmagny	Montmagny	11,320 sf/pc
Les promenades du cuivre	Rouyn-Noranda	11,926 sf/pc
Plaza BBRF	Sherbrooke	4,000 sf/pc
Plaza de l'ouest	Sherbrooke	3,600 sf/pc
Promenades St-François	Laval	1,095 sf/pc

FD*: Future Development / À venir

ND*: New Development / Nouveau développement

New/Nouveau Brunswick

OPEN UNITS
DISPONIBILITÉS





Dieppe Boulevard Plaza

530 – 570 Dieppe Boulevard, Dieppe NB

FPI
plaza
REIT



- Future Development Opportunities / À Venir:
 - Unit / Unité B – 10,000 sf/pc
 - Unit / Unité C – 1,0,000 sf/pc
- Anchor tenants / Majeurs:
 - Atlantic Superstore
 - Shoppers Drug Mart

Contact:
Brian Wall – (506) 461-6456
brian.wall@plaza.ca

[Flyer / Brochure](#)

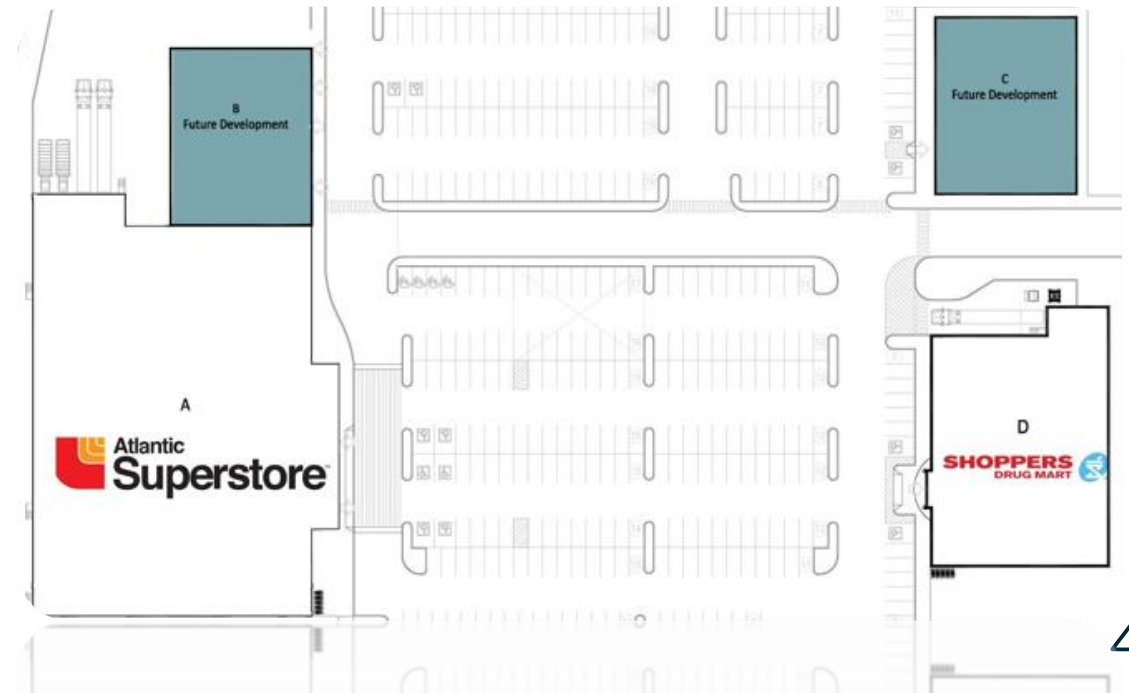



Petitcodiac Plaza

30 – 40 Champlain Street, Dieppe NB



- Future Development Opportunities / À Venir
 - Unit A – 18,000 sf/pc
- Open Units / Disponibilités
 - Unit / Unité E – 3,756 sf/pc
 - Unit / Unité F – 3,001 sf/pc
- Anchor Tenants / Majeurs:
 - Ren's Pet Depot
 - Dollarama

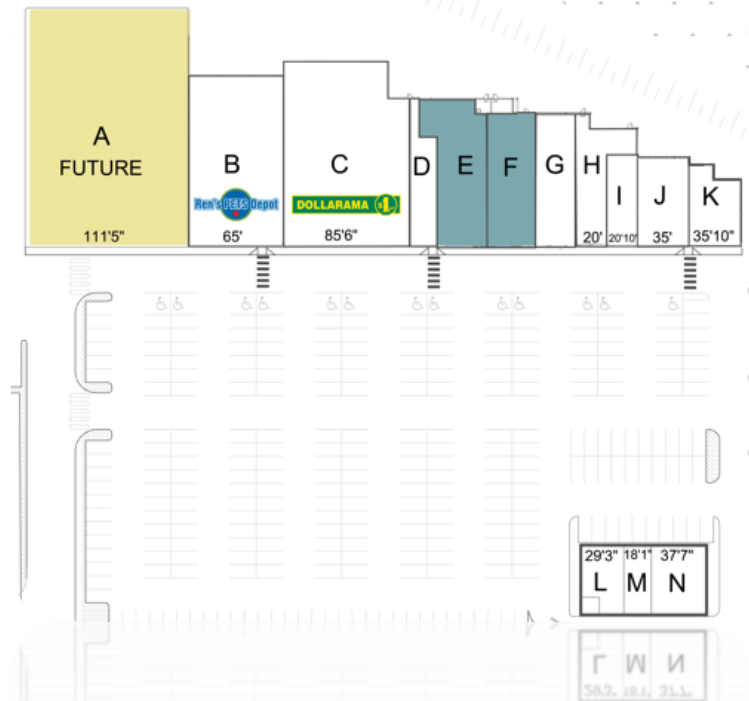

Contact:
 Brian Wall – (506) 461-6456
brian.wall@plaza.ca

Flyer / Brochure





Northumberland Square

2441 King George Hwy, Miramichi NB

FPI
plaza
REIT



- **Open Units / Disponibilités:**

- Unit A – 1,135 sf/pc
- Unit B – 4,005 sf/pc
- Unit D – 7,000 sf/pc

- **Future Development / À Venir:**

- Unit AA – 4,800 sf/pc
- Unit BB – 4,800 sf/pc

- **Anchor Tenants / Majeurs:**

- Winners, Hart, SportChek
- Giant Tiger, McDonalds
- Pet Smart



Contact:

Brian Wall – (506) 461-6456

brian.wall@plaza.ca

Flyer / Brochure





Oromocto Plaza

1198 Onondaga St, Oromocto NB

FPI
plaza
REIT



- Open Units / Disponibilités:
 - Unit C – 3,540 sf/pc
 - Unit K – 2,092 sf/pc
 - Unit M – 2,694 sf/pc

- Anchor Tenants / Mojeurs:
 - Shoppers Drug Mart
 - Dollarama

Contact:
Brian Wall – (506) 461-6456
brian.wall@plaza.ca

[Flyer / Brochure](#)





Fairville Blvd Plaza

1, 2, 20,30,31 Plaza Ave & Fairville Blvd Saint John NB



- Open Units / Disponibilités:
 - Unit / Unité O – 10,060 sf/pc
- Future Development / À Venir:
 - Unit / Unité AA – 6,800 sf/pc
 - Unit / Unité BB – 1,460 sf/pc
 - Unit / Unité CC – 3,400 sf/pc

- Anchor Tenants / Majeurs:
 - Sobeys
 - Dollarama

Contact:
 Brian Wall – (506) 461-6456
brian.wall@plaza.ca

[Flyer / Brochure](#)





Lansdowne Plaza

55 – 58 & 145 Lansdowne Ave, Saint John NB

FPI
plaza
REIT



- Open Units / Disponibilités:
 - Unit / Unité B – 6,571 sf/pc
 - Unit / Unité N – 1,500 sf/pc

- Anchor Tenants / Majeurs:
 - Shoppers Drug Mart, Subway
 - Dollarama, Tim Hortons

Contact:
Brian Wall – (506) 461-6456
brian.wall@plaza.ca

[Flyer / Brochure](#)





Gateway Mall

100, 110, 132, 138 – 140 Main Street, Sussex NB



- Open Units / Disponibilités:
 - Unit / Unité L – 2,485 sf/pc

- Anchor Tenants / Majeurs:
 - Sobeys
 - Canadian Tire



Contact:
 Brian Wall – (506) 461-6456
brian.wall@plaza.ca

[Flyer / Brochure](#)

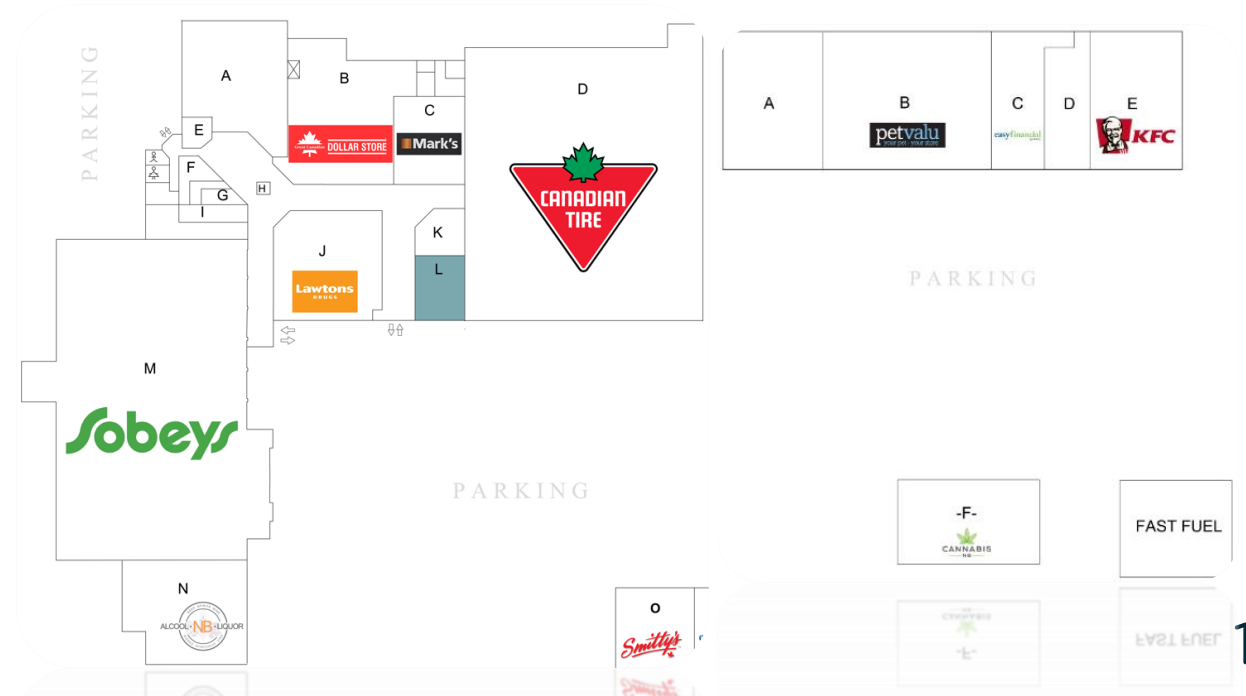

A map of Prince Edward Island, Canada, with a location pin at Charlottetown. The map is light blue and shows the island's coastline and major roads. The text "Charlottetown" is written next to the pin.

Prince Edward Island Île-du-Prince-Édouard

AVAILABLE OPPORTUNITIES
DISPONIBILITÉS

Buchanan Street Plaza

4180 Buchanan Drive, Charlottetown PE

FPI
plaza
REIT



- Open Units / Disponibilités:
 - Unit / Unité A – 34,474 sf/pc

- Anchor Tenants / Majeurs:
 - Penningtons, Reitmans

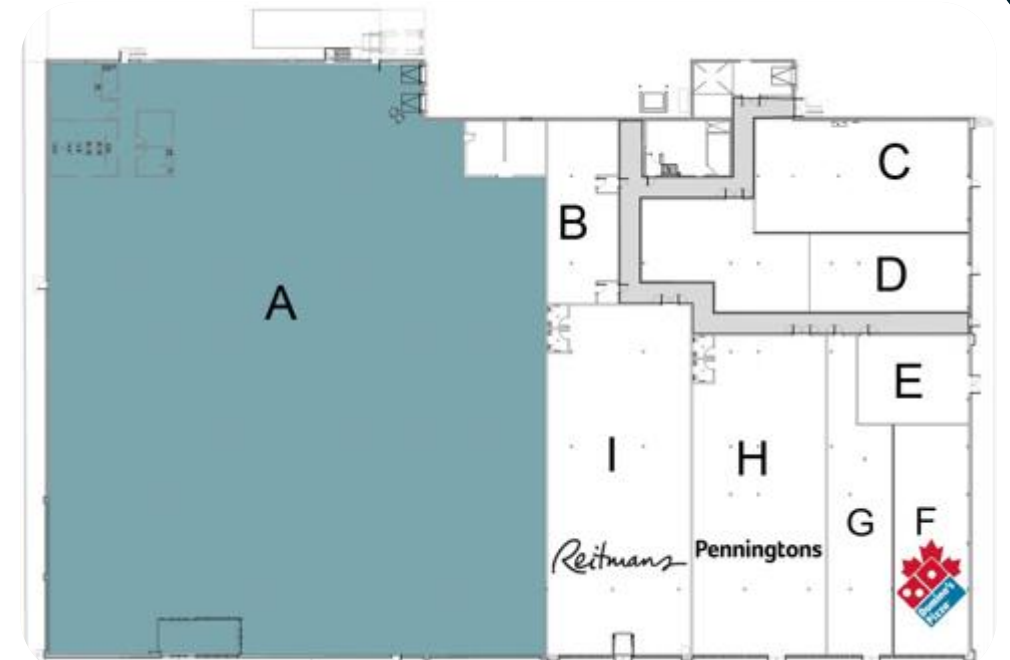

Contact:
Tim Bourque – (902) 499-1077
Tim.bourque@plaza.ca

[Flyer /Brochure](#)

Nova Scotia Nouvelle Écosse

AVAILABLE OPPORTUNITIES
DISPONIBILITÉS





Commercial Street Plaza

9275 – 9293 Commercial St, New Minas NS

FPI
plaza
REIT



- Open Units / Disponibilités:
 - Unit / Unité D – 4,000 sf/pc

- Anchor Tenants / Majeurs:
 - Swiss Chalet
 - Harveys
 - Sleep Country

Contact:
Tim Bourque – (902) 499-1077
Tim.bourque@plaza.ca

[Flyer / Brochure](#)

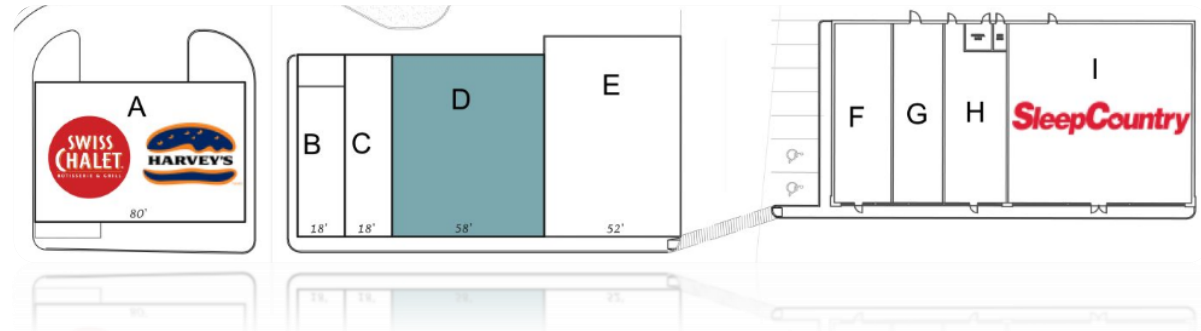



Granite Drive Plaza

20 – 52 – 54 Silver Fox Avenue, New Minas NS

FPI
plaza
REIT



- Open Units / Disponibilités:
 - Unit / Unité C – 1,829 sf/pc

- Anchor Tenants / Majeurs:
 - Winners / HomeSense
 - Lawtons Drugs
 - Dollarama



Contact:
Tim Bourque – (902) 499-1077
Tim.bourque@plaza.ca

[Flyer / Brochure](#)



Pleasant Street Plaza

56 Starrs Rd, Yarmouth NS



- Open Units / Disponibilités:
 - Unit / Unité B – 5,107 sf/pc
- Future Development / À Venir:
 - Unit / Unité C – 2,500 sf/pc

- Anchor Tenants / Majeurs:
 - Shoppers Drug Mart



Contact:
Tim Bourque – (902) 499-1077
Tim.bourque@plaza.ca

[Flyer /Brochure](#)

Chain Lake Drive

201 Chain Lake Drive, Halifax NS



- Open Units / Disponibilités:
 - Unit / Unité L – 6,945 sf/pc

- Anchor Tenants / Majeurs:
 - Pet Smart, Party City
 - Giant Tiger

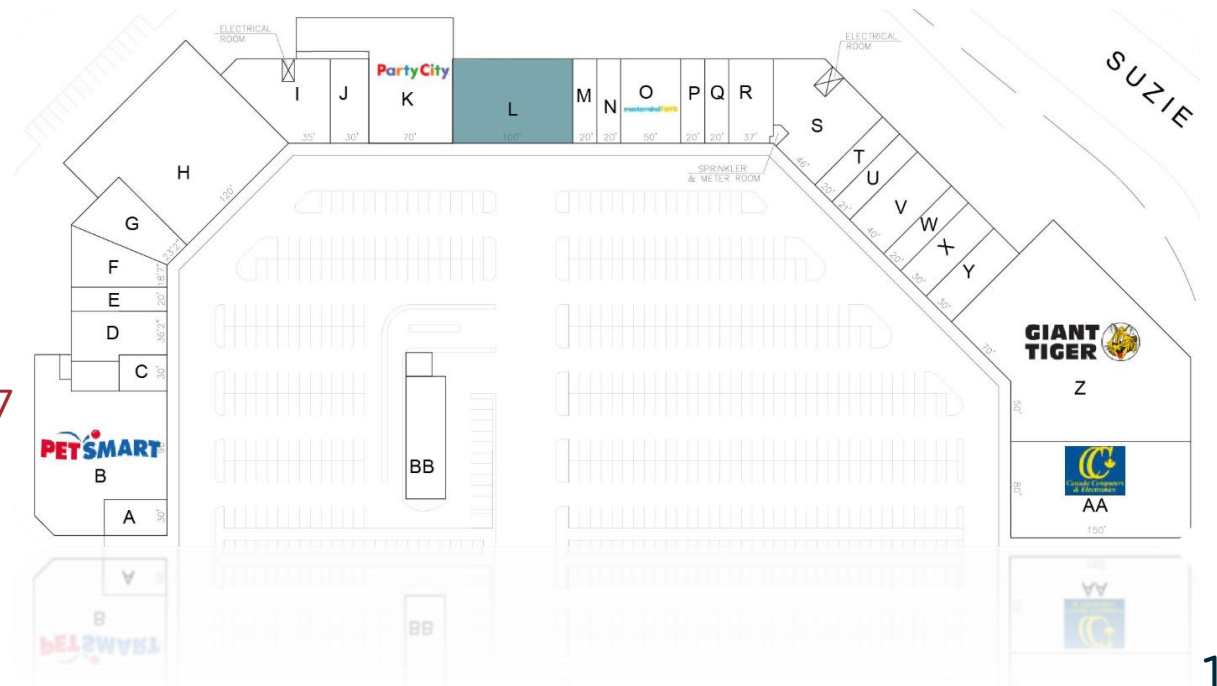

Contact:
Tim Bourque – (902) 499-1077
Tim.bourque@plaza.ca

Flyer /Brochure

Newfoundland Terre Neuve

AVAILABLE OPPORTUNITIES
OPPORTUNITÉS





The Village Shopping Centre

430 Topsail Rd, St. John's NL

FPI
plaza
REIT



- Open Units / Disponibilités:
 - Unit / Unité 1B & C – 17,249 sf/pc
 - Unit / Unit/ E to G – 12,420 sf/pc
 - Unit / Unité 1J – 4,096 sf/pc
 - Unit / Unité 1K – Kiosk / Kiosque
 - Unit / Unité 1L – Kiosk / Kiosque
 - Unit / Unité M & N – 594 sf/pc
 - Unit / Unité 1W & X – 20,179 sf/pc
 - Unit / Unité 1HH – 7,013 sf/ρ
 - Unit / Unité 1PP – 2,542 sf/pc

- Anchor Tenants / Majeurs:
 - No Frills, SportChek, Urban Planet
 - Dollarama, Pipers, Home Hardware

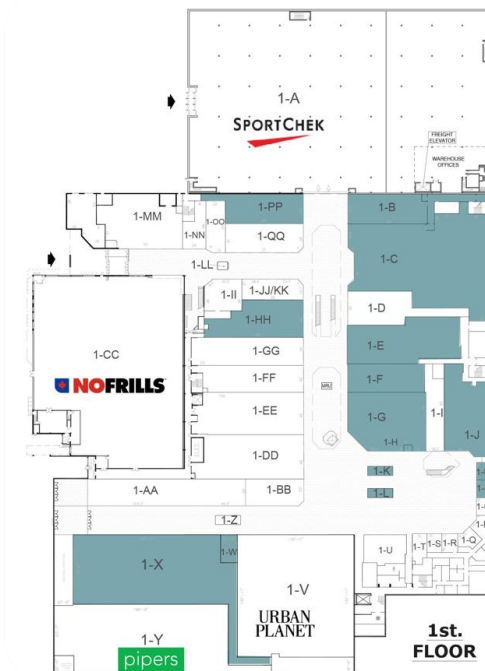

Contact:
Tim Bourque – (902) 499-1077
Tim.bourque@plaza.ca

[Flyer / Brochure](#)





The Village Shopping Centre

430 Topsail Rd, St. John's NL

FPI
plaza
REIT



- **Open Units / Disponibilités:**
 - Unit / Unité 2C & D – 3,183 sf/pc
 - Unit / Unité 2H – kiosk/kiosque
 - Unit / Unité 2L – 2,668 sf/pc
 - Unit / Unité 2DD – 1,630 sf/pc
 - Unit / Unité 2O to Q – 4,139 sf/pc
 - Unit / Unité R – 755 sf/pc
 - Unit / Unité 2S – 1,821 sf/pc
 - Unit / Unité 2Z to BB – 21,842 sf/pc
 - Unit / Unité 2DD & EE – 2,818 sf/p
 - Unit / Unité 2HH & II – 2,256sf/pc

Contact:
 Tim Bourque – (902) 499-1077
Tim.bourque@plaza.ca

[Flyer / Brochure](#)





The Shoppes at Galway

75 Danny Drive, St. John's NL

FPI
plaza
REIT



- Open Units / Disponibilités:
 - Unit / Unité EA – 2,450 sf/pc

- Anchor Tenants / Majeurs:
 - Costco, Princess Auto
 - Starbucks



Contact:
Tim Bourque – (902) 499-1077
Tim.bourque@plaza.ca

[Flyer / Brochure](#)



The Shoppes at Galway

75 Danny Drive, St. John's NL



- **Future Development / À Venir:**
 - Unit / Unité AA – 45,856 sf/pc
 - Unit / Unité AB – 10,452 sf/pc
 - Unit / Unité AC – 15,000 sf/pc
 - Unit / Unité AD – 6,015 sf/pc
 - Unit / Unité AE – 1,400 sf/pc
 - Unit / Unité AF – 1,200sf/pc
 - Unit / Unité AG – 3,332sf/pc
 - Unit / Unité AH – 6,043sf/pc
 - Unit / Unité AI – 4,075 sf/pc
 - Unit / Unité AJ – 1,400sf/pc

- Unit / Unité AK – 1,500sf/pc
- Unit / Unité AL – 1,800sf/pc
- Unit / Unité AM to AO – 1,500sf/pc
- Unit / Unité AR – 1,600sf/pc

Contact:
 Tim Bourque – (902) 499-1077
Tim.bourque@plaza.ca

[Flyer / Brochure](#)





Kenmount Road Plaza

80 Kenmount Road, St. John's NL

FPI
plaza
REIT



- Open Units / Disponibilités:
 - Unit / Unité C – 2,335 sf/pc

- Anchor Tenants / Majeurs:
 - Montana's
 - Cora

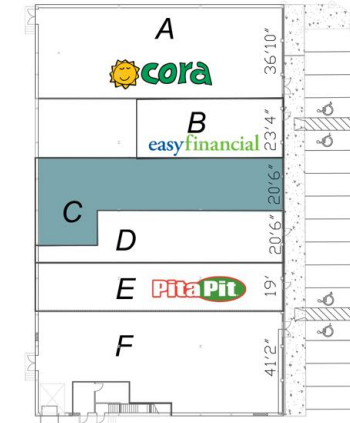

Contact:
Tim Bourque – (902) 499-1077
Tim.bourque@plaza.ca

[Flyer / Brochure](#)

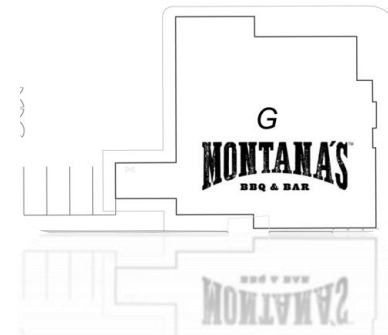

Ontario



AVAILABLE OPPORTUNITIES
DISPONIBILITÉS



1000 Islands Plaza

2399 Parkedale Ave, Brockville ON

FPI
plaza
REIT



- **Open Units / Disponibilités:**
 - Unit / Unité E – 6,400+ sf/pc
- (Space is divisible / Espace divisible)

No Frills: opening/ouverture April/avril 2026

- **Anchor Tenants / Majeurs:**
 - Shoppers Drug Mart
 - Dollarama, Leon's, Staples



Contact:
 Sacha Singh – (514) 476-8833
Sacha.singh@plaza.ca

Flyer / Brochure



Eastcourt Plaza

1380 Second St East, Cornwall ON

FPI
plaza
REIT



- Open Units / Disponibilités:
 - Unit / Unité Q – 14,691 sf/pc
 - Unit / Unité W – 4,500 sf/pc

- Anchor Tenants / Majeurs:
 - No Frills
 - Shoppers Drug Mart

Contact:
Sacha Singh – (514) 476-8833
Sacha.singh@plaza.ca

[Flyer / Brochure](#)





Timiskaming Plaza

Hwy 65, RR#2, New Liskeard ON

FPI
plaza
REIT



- Future Development / À Venir:
 - Unit / Unité M – TBD sf/pc

- Anchor Tenants / Majeurs:
 - Food Basics
 - Shoppers Drug Mart



Contact:
Sacha Singh – (514) 476-8833
Sacha.singh@plaza.ca

Flyer / Brochure



Northern Avenue Plaza

248 Northern Ave E, Sault Ste Marie ON

FPI
plaza
REIT



- Open Units / Disponibilités:
 - Unit / Unité F – 600 sf/pc
 - Unit / Unité G – 1,257 sf/pc
 - Unit / Unité H – 1,617 sf/pc

- Anchor Tenants / Majeurs:
 - Metro, Winners/Home Sense
 - Princess Auto

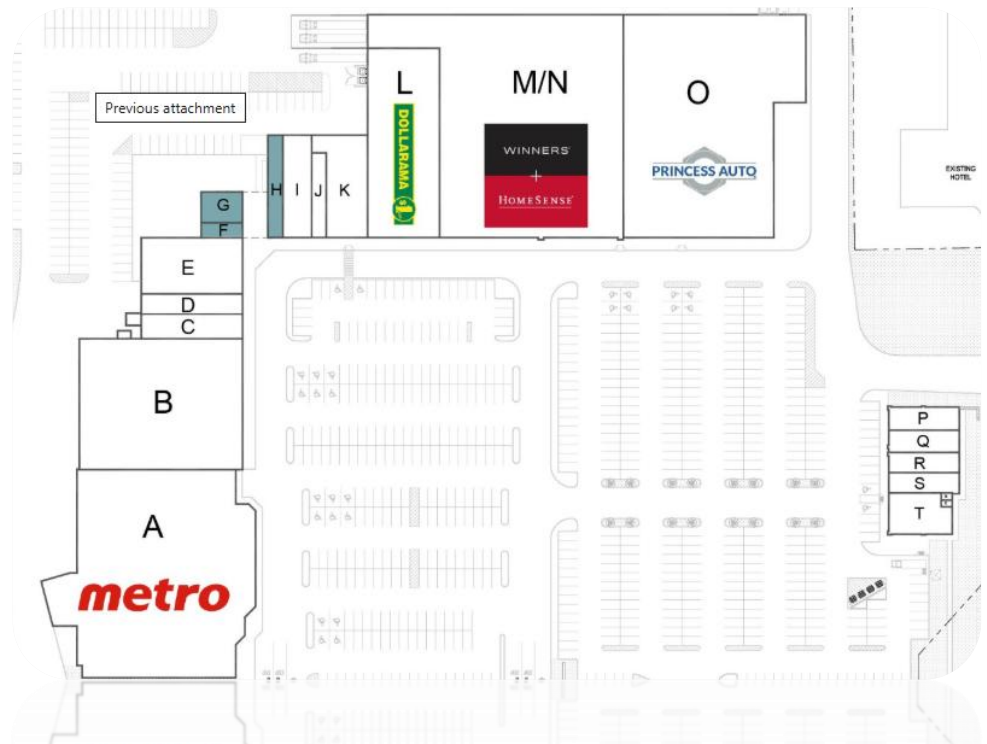

Contact:
 Sacha Singh – (514) 476-8833
Sacha.singh@plaza.ca

Flyer / Brochure



Niagara St & Quaker Rd Plaza

968 Niagara St, Welland ON

Tenants have taken delivery as of April 2026.

Les locataires ont pris livraison des locaux en avril 2026.

FPI
plaza
REIT

- Open Units / Disponibilités:
 - Unit / Unité C – 9,914 sf/pc
 - Unit / Unité D – 5,200 sf/pc
 - Units / Unités G – 1,720 sf/pc
 - Unit / Unité J – 1,500 sf/pc
 - Unit / Unité K – 1,300 sf/pc
 - Unit / Unité L – 1855 sf/pc
 - Unit / Unité N – 1,538 sf/pc
 - Unit / Unité Q – 1,255 sf/pc

- Anchor Tenants / Majeurs:
 - Longo's, Dollarama



Contact:
Sacha Singh – (514) 476-8833
Sacha.singh@plaza.ca

[Flyer / Brochure](#)

Québec

AVAILABLE OPPORTUNITIES
DISPONIBILITÉS





Plaza Charles-A-Cadieux

65 route du Président-Kennedy, Lévis QC



- Open Units / Disponibilités:
 - Unit / Unité J – 1,815 sf/pc

- Anchor Tenants / Majeurs:
 - Michaels
 - Bulk Barn



Contact:
Sacha Singh – (514) 476-8833
Sacha.singh@plaza.ca

[Flyer / Brochure](#)

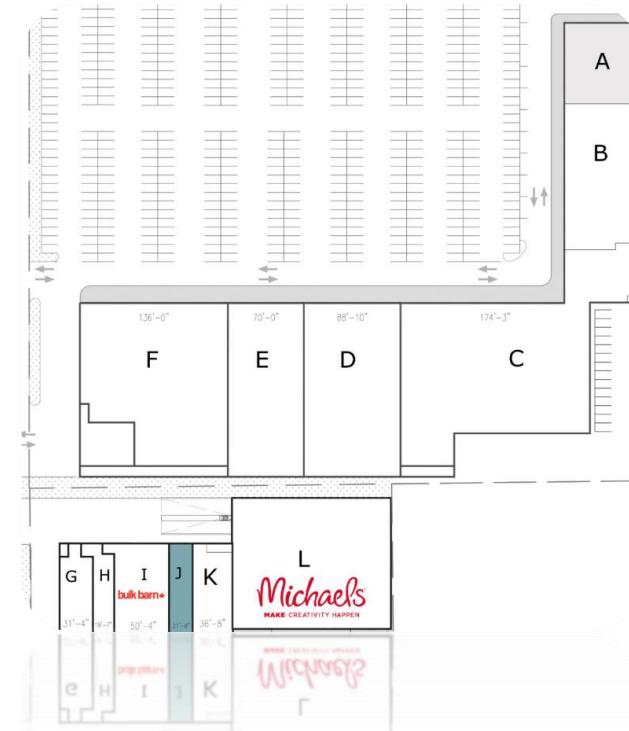



Plaza boulevard Royal

1702 41^e rue, Shawinigan QC



- Open Units / Disponibilités:
 - Unit / Unité N – 13,625 sf/pc
(Office Space - Divisible / Espace de bureau - divisible)

- Anchor Tenants / Majeurs:
 - Rossy
 - Dollarama

Contact:
 Sacha Singh – (514) 476-8833
Sacha.singh@plaza.ca
[Flyer / Brochure](#)





Les galeries Montmagny

81 et 101 boulevard Taché, Montmagny QC

FPI
plaza
REIT



- Open Units / Disponibilités:
 - Unit / Unité E – 500 sf/pc
 - Unit / Unité F – 738 sf/pc
 - Unit / Unité H – 1,654 sf/pc
 - Unit / Unité L – 910 sf/pc
 - Unit / Unité O à Q – 4,458 sf/pc
 - Unit / Unité T – 1,310 sf/pc
 - Unit / Unité V et W – 1,000 sf/pc
 - Unit / Unité Y – 750 sf/pc

Contact:
Sacha Singh – (514) 476-8833
Sacha.singh@plaza.ca

[Flyer / Brochure](#)

- Anchor Tenants / Majeurs:
 - Maxi
 - Dollarama
 - Sports Experts

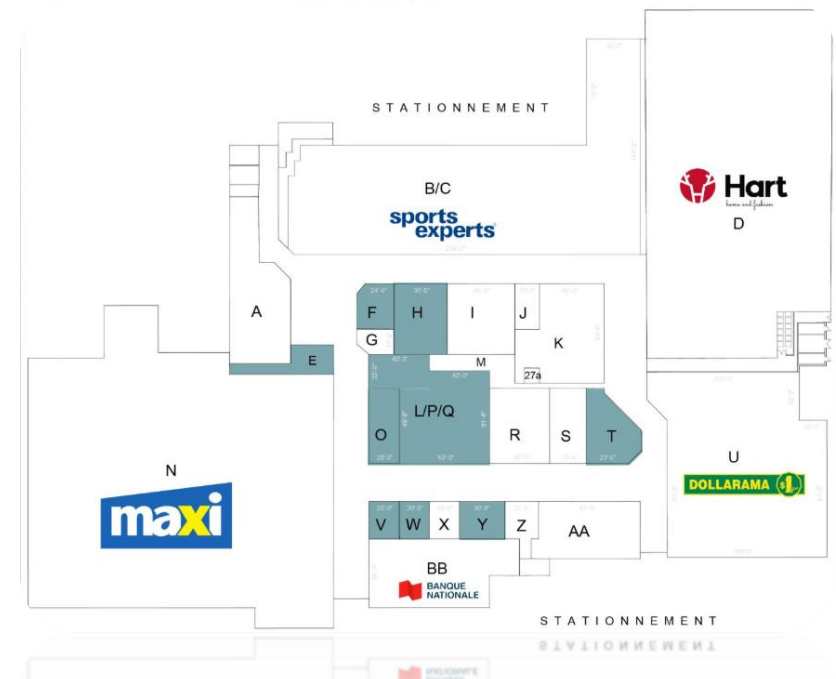



Les promenades du cuivre

Rue Terminus ouest, Rouyn-Noranda QC

FPI
plaza
REIT

- Open Units / Disponibilités:
 - Unit / Unité F – 1,248 sf/pc
 - Unit / Unité G – 924 sf/pc
 - Unit / Unité H – 1,313 sf/pc
 - Unit / Unité J – 832 sf/pc
 - Unit / Unité AA – 1,196 sf/pc
 - Unit / Unité HH – 1,433 sf/pc
 - Unit / Unité II – 2,213 sf / pc
 - Unit / Unité MM – 2,767 sf/pc
 - Kiosk / Kiosque NN

- Anchor Tenants / Majeurs:
 - Pharmaprix
 - Winners
 - Bureau en gros

Contact:
Sacha Singh – (514) 476-8833
Sacha.singh@plaza.ca

Flyer / Brochure

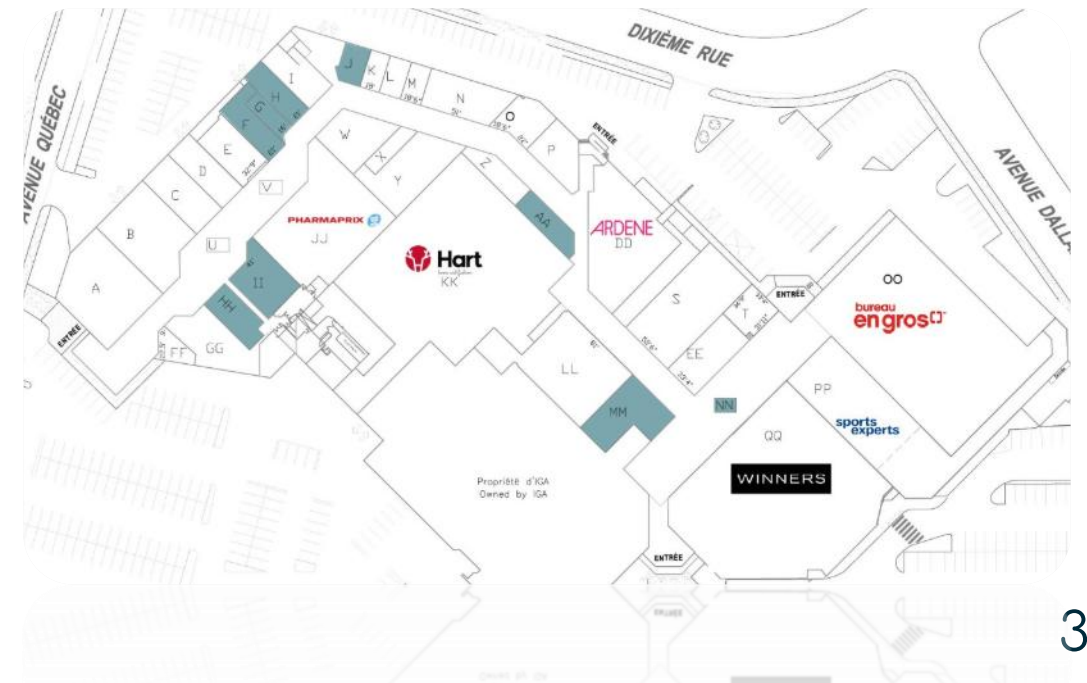

Plaza BBRF

5050 boulevard Bourque, Sherbrooke QC

FPI
plaza
REIT



- **Open Units / Disponibilités:**
 - Unit / Unité B – 4,000 sf/pc

Can be divided and can be made to accommodate drive-through service and terrace. / Divisible avec possibilité de service-au-volant et terrasse.

- **Anchor Tenants / Majeurs:**
 - Pharmaprix

Contact:
Sacha Singh – (514) 476-8833
Sacha.singh@plaza.ca

[Flyer / Brochure](#)

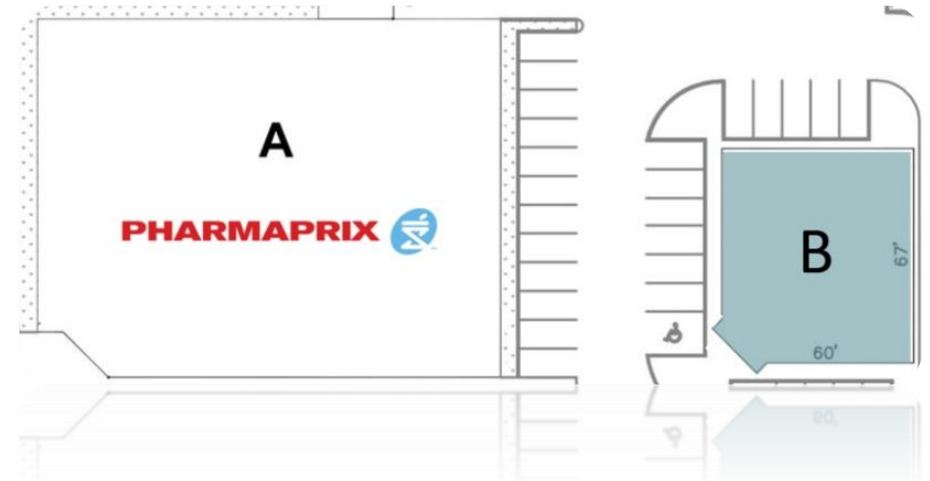



Plaza de l'ouest

4857 boulevard Bourque, Sherbrooke QC

FPI
plaza
REIT



- Future Development / À Venir:
 - Unit / Unité W – 3,600 sf/pc

- Anchor Tenants / Majeurs:
 - Metro, Brunet, Dollarama



Contact:
Sacha Singh – (514) 476-8833
Sacha.singh@plaza.ca

Flyer / Brochure





Les promenades St-François

600 Montée du Moulin, Laval QC



- Open Units / Disponibilités:
 - Unit / Unité H – 1,095 sf/pc

- Anchor Tenants / Majeurs:
 - Rona, Dollarama
 - Desjardins, Jean Coutu

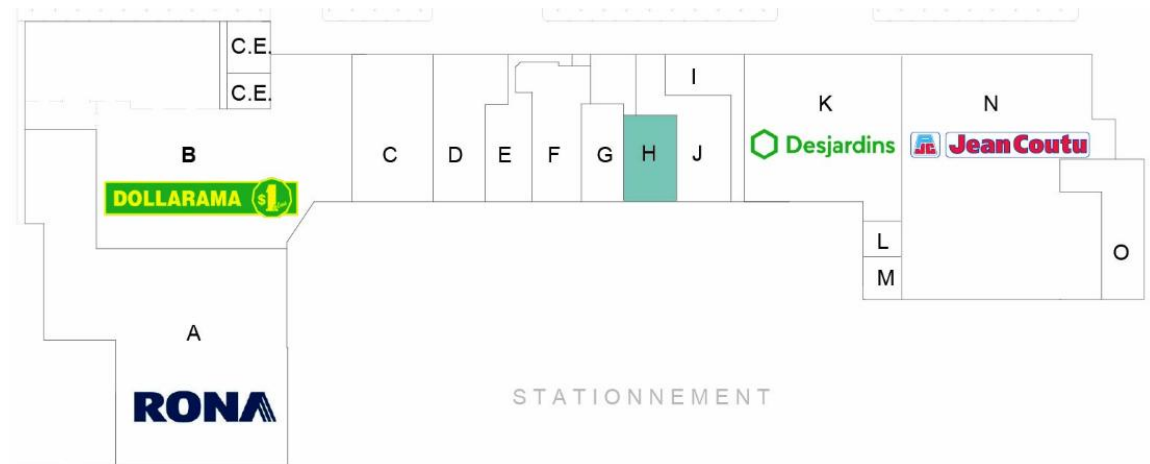

Contact:
Sacha Singh – (514) 476-8833
Sacha.singh@plaza.ca

[Flyer / Brochure](#)

Meet the TEAM!



Mathieu Bordeleau

Mathieu.bordeleau@plaza.ca



Brian Wall

Brian.wall@plaza.ca



Tim Bourque

Tim.bourque@plaza.ca



Sacha Singh

Sacha.singh@plaza.ca