

plaza
REIT

OPEN UNITS /
DISPONIBILITÉS

New / Nouveau Brunswick		
Dieppe Boulevard Plaza	Dieppe	15,368 sf/pc
Petitcodiac Plaza	Dieppe	24,757 sf/pc
Northumberland Square	Miramichi	21,740 sf/pc
Oromocto Plaza	Oromocto	8,326 sf/pc
Fairville Blvd Plaza	Saint John	10,060 sf/pc
Lansdowne Plaza	Saint John	8,071 sf/pc
Gateway Mall	Sussex	2,485 sf/pc

Newfoundland/Terre-Neuve		
The Village Shopping Centre	St John's	+/-97,000 sf/pc
The Shoppes at Galway	St John's	2,450 sf/pc
The Shoppes at Galway FD*	St John's	+/-104,000 sf/pc
Kenmount Road Plaza	St-John's	2,335 sf/pc

Ontario		
1000 Islands Plaza	Brockville	6,400+ sf/pc
Eastcourt Plaza	Cornwall	19,191 sf/pc
Timiskaming Plaza	New-Liskeard	FD – À Venir
Northern Avenue Plaza	Sault Ste Marie	3,474 sf/pc
Niagara St & Quaker Rd	Welland	24,282 sf/pc

Nova Scotia/Nouvelle Écosse		
Commercial Street Plaza	New Minas	4,000 sf/pc
Granite Drive	New Minas	1,829 sf/pc
Pleasant Street Plaza	Yarmouth	5,107 sf/pc
Chain Lake Drive	Halifax	6,945 sf/pc

PEI / IPE		
Buchanan Street Plaza	Charlottetown	34,474 sf/pc

Québec		
Plaza Charles-A-Cadieux	Lévis	1,815 sf/pc
5865-5875 Rue des Arpents	Lévis	1,650 sf/pc
Plaza Boulevard Royal	Shawinigan	13,625 sf/pc
Les galeries Montmagny	Montmagny	11,320 sf/pc
Les promenades du cuivre	Rouyn-Noranda	11,926 sf/pc
Plaza BBRF	Sherbrooke	4,000 sf/pc
Plaza de l'ouest	Sherbrooke	3,600 sf/pc
Promenades St-François	Laval	1,095 sf/pc

FD*: Future Development / À venir

ND*: New Development / Nouveau développement

New/Nouveau Brunswick

OPEN UNITS
DISPONIBILITÉS





Dieppe Boulevard Plaza

530 – 570 Dieppe Boulevard, Dieppe NB

FPI
plaza
REIT



- Future Development Opportunities / À Venir:
 - Unit / Unité B – 10,000 sf/pc
 - Unit / Unité C – 1,0,000 sf/pc
- Anchor tenants / Majeurs:
 - Atlantic Superstore
 - Shoppers Drug Mart

Contact:
Brian Wall – (506) 461-6456
brian.wall@plaza.ca

[Flyer / Brochure](#)

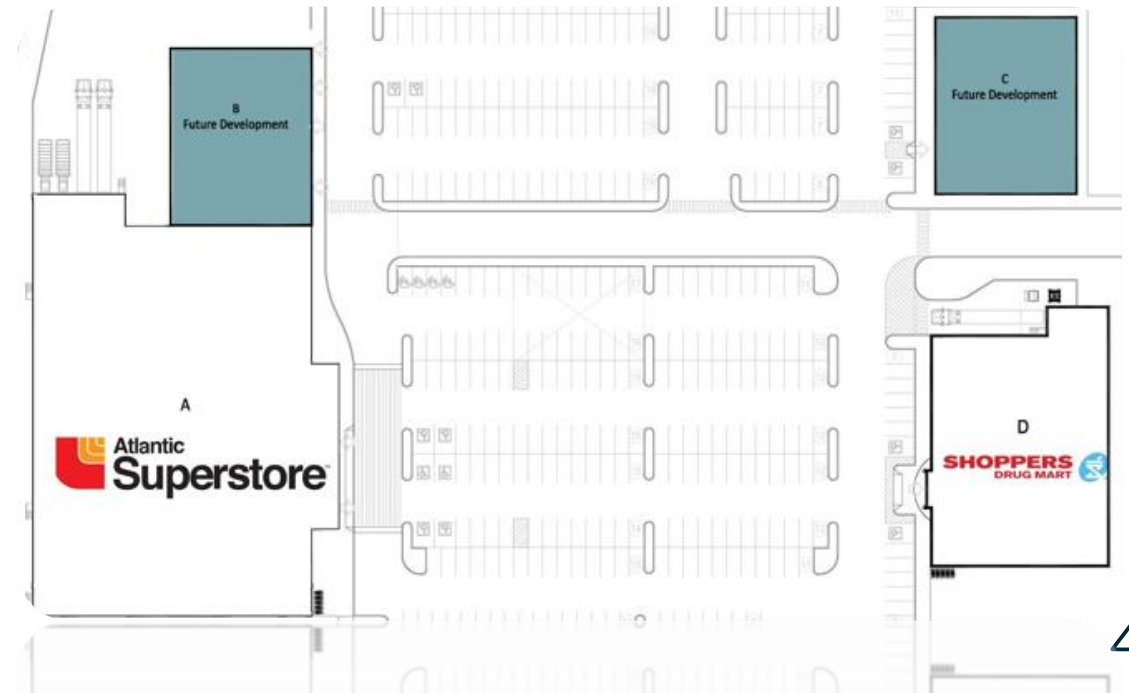



Petitcodiac Plaza

30 – 40 Champlain Street, Dieppe NB



- Future Development Opportunities / À Venir
 - Unit A – 18,000 sf/pc
- Open Units / Disponibilités
 - Unit / Unité E – 3,756 sf/pc
 - Unit / Unité F – 3,001 sf/pc
- Anchor Tenants / Majeurs:
 - Ren's Pet Depot
 - Dollarama

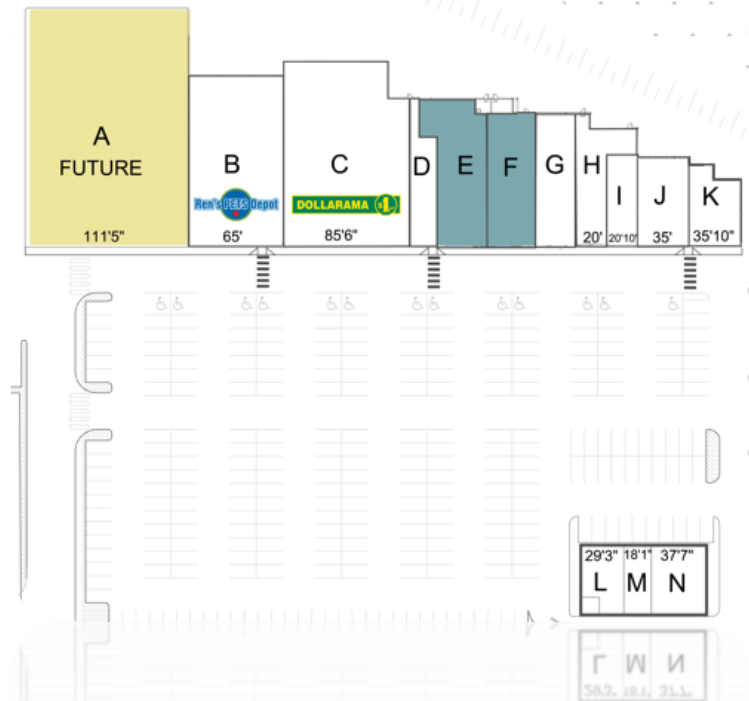

Contact:
 Brian Wall – (506) 461-6456
brian.wall@plaza.ca

Flyer / Brochure





Northumberland Square

2441 King George Hwy, Miramichi NB

FPI
plaza
REIT



- **Open Units / Disponibilités:**

- Unit A – 1,135 sf/pc
- Unit B – 4,005 sf/pc
- Unit D – 7,000 sf/pc

- **Future Development / À Venir:**

- Unit AA – 4,800 sf/pc
- Unit BB – 4,800 sf/pc

- **Anchor Tenants / Majeurs:**

- Winners, Hart, SportChek
- Giant Tiger, McDonalds
- Pet Smart



Contact:

Brian Wall – (506) 461-6456

brian.wall@plaza.ca

Flyer / Brochure





Oromocto Plaza

1198 Onondaga St, Oromocto NB

FPI
plaza
REIT



- Open Units / Disponibilités:
 - Unit C – 3,540 sf/pc
 - Unit K – 2,092 sf/pc
 - Unit M – 2,694 sf/pc

- Anchor Tenants / Mojeurs:
 - Shoppers Drug Mart
 - Dollarama

Contact:
Brian Wall – (506) 461-6456
brian.wall@plaza.ca

[Flyer / Brochure](#)





Fairville Blvd Plaza

1, 2, 20,30,31 Plaza Ave & Fairville Blvd Saint John NB

FPI
plaza
REIT



- Open Units / Disponibilités:
 - Unit / Unité O – 10,060 sf/pc

- Anchor Tenants / Majeurs:
 - Sobeys
 - Dollarama

Contact:
Brian Wall – (506) 461-6456
brian.wall@plaza.ca

[Flyer / Brochure](#)





Lansdowne Plaza

55 – 58 & 145 Lansdowne Ave, Saint John NB



- Open Units / Disponibilités:
 - Unit / Unité B – 6,571 sf/pc
 - Unit / Unité N – 1,500 sf/pc

- Anchor Tenants / Majeurs:
 - Shoppers Drug Mart, Subway
 - Dollarama, Tim Hortons

Contact:
Brian Wall – (506) 461-6456
brian.wall@plaza.ca

[Flyer / Brochure](#)





Gateway Mall

100, 110, 132, 138 – 140 Main Street, Sussex NB



- Open Units / Disponibilités:
 - Unit / Unité L – 2,485 sf/pc

- Anchor Tenants / Majeurs:
 - Sobeys
 - Canadian Tire



Contact:
 Brian Wall – (506) 461-6456
brian.wall@plaza.ca

[Flyer / Brochure](#)

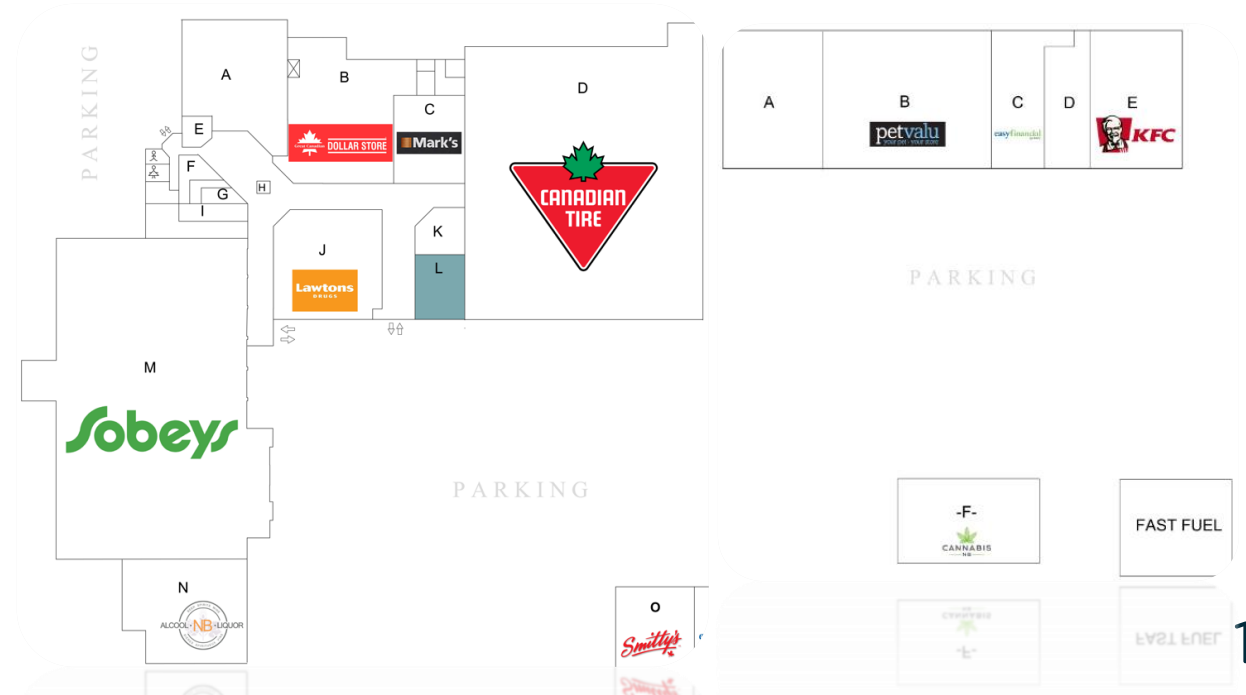

A map of Prince Edward Island, Canada, with a location pin at Charlottetown. The map is light blue and shows the island's coastline and major roads. The text "Charlottetown" is written in blue next to the pin.

Prince Edward Island Île-du-Prince-Édouard

AVAILABLE OPPORTUNITIES
DISPONIBILITÉS

Buchanan Street Plaza

180 Buchanan Drive, Charlottetown PE

FPI
plaza
REIT



- Open Units / Disponibilités:
 - Unit / Unité A – 34,474 sf/pc

- Anchor Tenants / Majeurs:
 - Penningtons, Reitmans

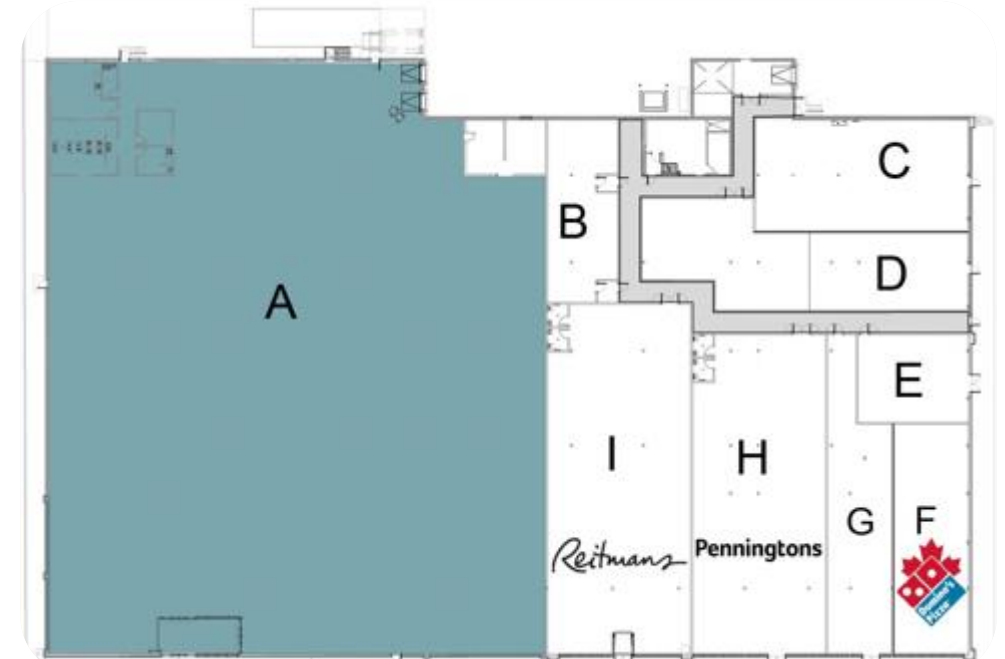

Contact:
Tim Bourque – (902) 499-1077
Tim.bourque@plaza.ca

[Flyer /Brochure](#)

Nova Scotia Nouvelle Écosse

AVAILABLE OPPORTUNITIES
DISPONIBILITÉS





Commercial Street Plaza

9275 – 9293 Commercial St, New Minas NS

FPI
plaza
REIT



- Open Units / Disponibilités:
 - Unit / Unité D – 4,000 sf/pc

- Anchor Tenants / Majeurs:
 - Swiss Chalet
 - Harveys
 - Sleep Country

Contact:
Tim Bourque – (902) 499-1077
Tim.bourque@plaza.ca

[Flyer / Brochure](#)

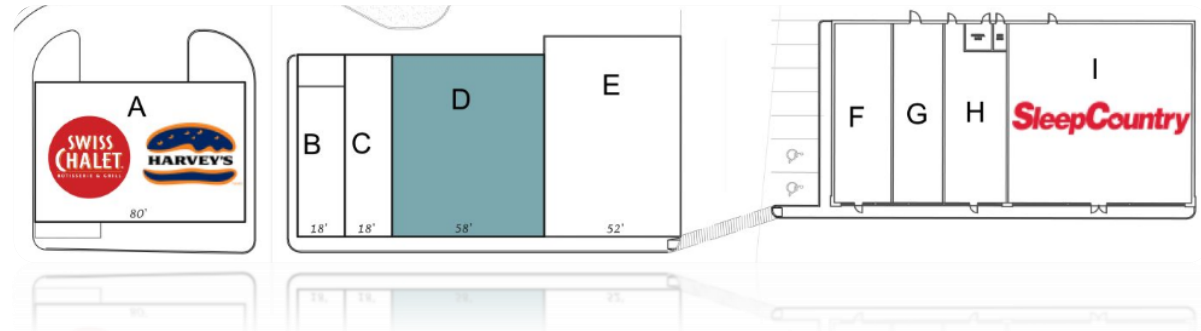

Granite Drive

20 – 52 – 54 Silver Fox, New Minas NS

FPI
plaza
REIT



- Available / Disponibilité:
 - Unit / Unité C – 1,829 sf/pc

- Anchor Tenants / Majeurs:
 - Winners / HomeSense
 - Lawtons, Dollarama

Contact:
Tim Bourque – (902) 499-1077
Tim.bourque@plaza.ca

[Flyer /Brochure](#)



Pleasant Street Plaza

56 Starrs Rd, Yarmouth NS



- Open Units / Disponibilités:
 - Unit / Unité B – 5,107 sf/pc
- Future Development / À Venir:
 - Unit / Unité C – 2,500 sf/pc

- Anchor Tenants / Majeurs:
 - Shoppers Drug Mart



Contact:
Tim Bourque – (902) 499-1077
Tim.bourque@plaza.ca

[Flyer /Brochure](#)

Chain Lake Drive

201 Chain Lake Drive, Halifax NS



- Open Units / Disponibilités:
 - Unit / Unité L – 6,945 sf/pc

- Anchor Tenants / Majeurs:
 - Pet Smart, Party City
 - Giant Tiger

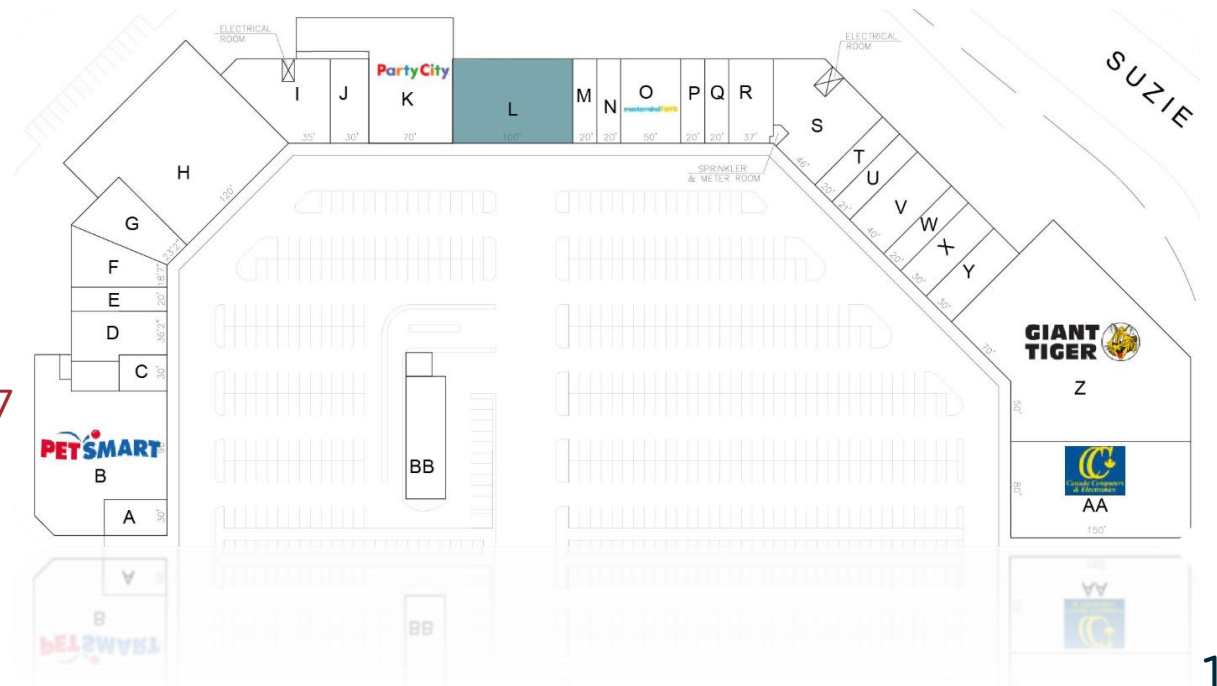

Contact:
Tim Bourque – (902) 499-1077
Tim.bourque@plaza.ca

Flyer /Brochure

Newfoundland Terre Neuve

AVAILABLE OPPORTUNITIES
OPPORTUNITÉS





The Village Shopping Centre

430 Topsail Rd, St. John's NL



- Open Units / Disponibilités:
 - Unit / Unité 1B & C – 17,249 sf/pc
 - Unit / Unit/ E to G – 12,420 sf/pc
 - Unit / Unité 1J – 4,096 sf/pc
 - Unit / Unité 1K – Kiosk / Kiosque
 - Unit / Unité 1L – Kiosk / Kiosque
 - Unit / Unité M & N – 594 sf/pc
 - Unit / Unité 1W & X – 20,179 sf/pc
 - Unit / Unité 1HH – 7,013 sf/ρ
 - Unit / Unité 1PP – 2,542 sf/pc

- Anchor Tenants / Majeurs:
 - No Frills, SportChek, Urban Planet
 - Dollarama, Pipers, Home Hardware

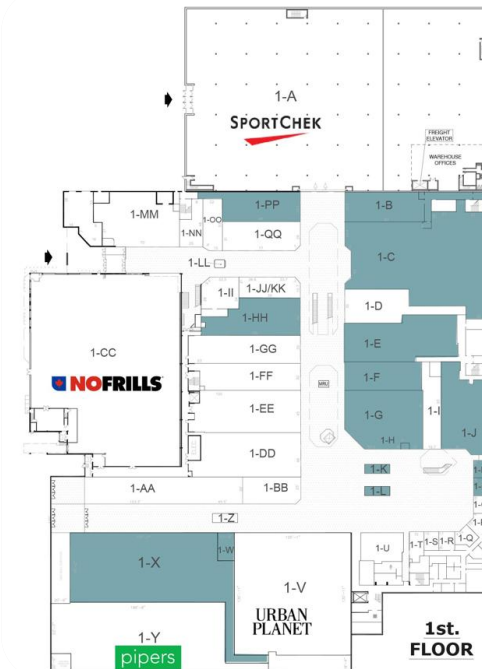

Contact:
Tim Bourque – (902) 499-1077
Tim.bourque@plaza.ca

Flyer / Brochure





The Village Shopping Centre

430 Topsail Rd, St. John's NL

FPI
plaza
REIT



- **Open Units / Disponibilités:**
 - Unit / Unité 2C & D – 3,183 sf/pc
 - Unit / Unité 2H – kiosk/kiosque
 - Unit / Unité 2L – 2,668 sf/pc
 - Unit / Unité 2DD – 1,630 sf/pc
 - Unit / Unité 2O to Q – 4,139 sf/pc
 - Unit / Unité R – 755 sf/pc
 - Unit / Unité 2S – 1,821 sf/pc
 - Unit / Unité 2Z to BB – 21,842 sf/pc
 - Unit / Unité 2DD & EE – 2,818 sf/p
 - Unit / Unité 2HH & II – 2,256sf/pc

Contact:
Tim Bourque – (902) 499-1077
Tim.bourque@plaza.ca

[Flyer / Brochure](#)





The Shoppes at Galway

75 Danny Drive, St. John's NL

FPI
plaza
REIT



- Open Units / Disponibilités:
 - Unit / Unité EA – 2,450 sf/pc

- Anchor Tenants / Majeurs:
 - Costco, Princess Auto
 - Starbucks



Contact:
Tim Bourque – (902) 499-1077
Tim.bourque@plaza.ca

[Flyer / Brochure](#)





The Shoppes at Galway

75 Danny Drive, St. John's NL

FPI
plaza
REIT



- Future Development / À Venir:
 - Unit / Unité AA – 45,856 sf/pc
 - Unit / Unité AB – 10,452 sf/pc
 - Unit / Unité AC – 15,000 sf/pc
 - Unit / Unité AD – 6,015 sf/pc
 - Unit / Unité AE – 1,400 sf/pc
 - Unit / Unité AF – 1,200sf/pc
 - Unit / Unité AG – 3,332sf/pc
 - Unit / Unité AH – 6,043sf/pc
 - Unit / Unité AI – 4,075 sf/pc
 - Unit / Unité AJ – 1,400sf/pc

- Unit / Unité AK – 1,500sf/pc
- Unit / Unité AL – 1,800sf/pc
- Unit / Unité AM to AO – 1,500sf/pc
- Unit / Unité AR – 1,600sf/pc

Contact:
Tim Bourque – (902) 499-1077
Tim.bourque@plaza.ca

[Flyer / Brochure](#)

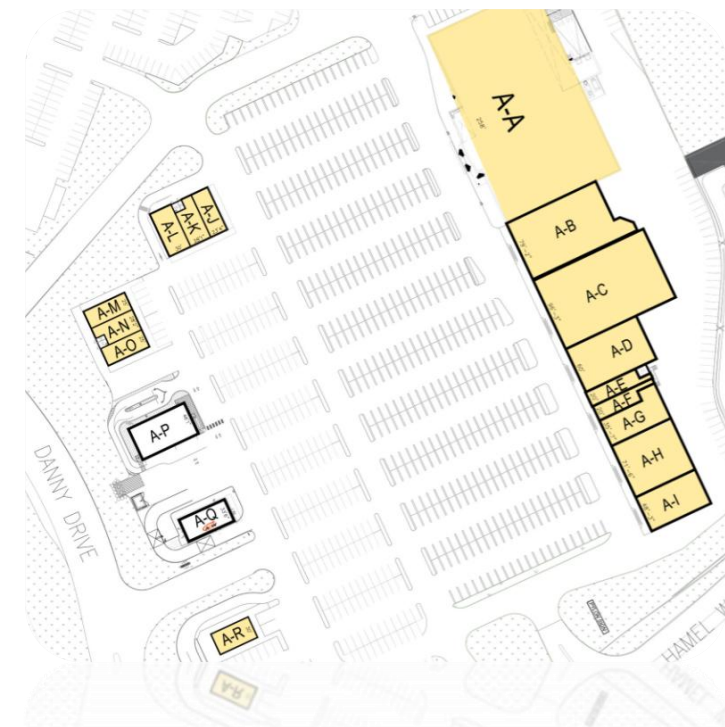



Kenmount Road Plaza

80 Kenmount Road, St. John's NL

FPI
plaza
REIT



- Open Units / Disponibilités:
 - Unit / Unité C – 2,335 sf/pc

- Anchor Tenants / Majeurs:
 - Montana's
 - Cora

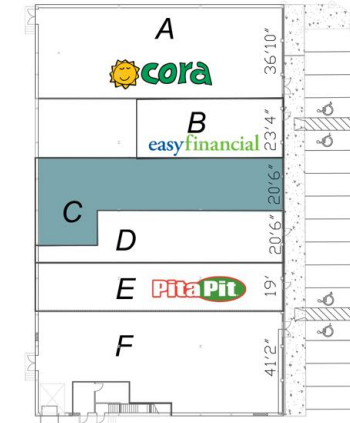

Contact:
Tim Bourque – (902) 499-1077
Tim.bourque@plaza.ca

[Flyer / Brochure](#)

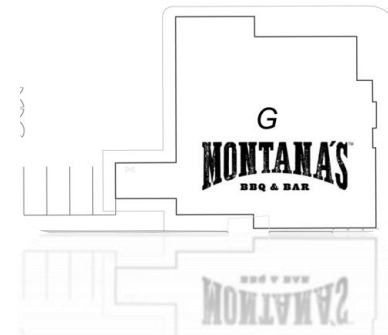

Ontario



AVAILABLE OPPORTUNITIES
DISPONIBILITÉS



1000 Islands Plaza

2399 Parkedale Ave, Brockville ON

FPI
plaza
REIT



- **Open Units / Disponibilités:**
 - Unit / Unité E – 6,400+ sf/pc
- (Space is divisible / Espace divisible)

No Frills: opening/ouverture April/avril 2026

- **Anchor Tenants / Majeurs:**
 - Shoppers Drug Mart
 - Dollarama, Leon's, Staples



Contact:
 Sacha Singh – (514) 476-8833
Sacha.singh@plaza.ca

Flyer / Brochure



Eastcourt Plaza

1380 Second St East, Cornwall ON

FPI
plaza
REIT



- Open Units / Disponibilités:
 - Unit / Unité Q – 14,691 sf/pc
 - Unit / Unité W – 4,500 sf/pc

- Anchor Tenants / Majeurs:
 - No Frills
 - Shoppers Drug Mart

Contact:
Sacha Singh – (514) 476-8833
Sacha.singh@plaza.ca

[Flyer / Brochure](#)

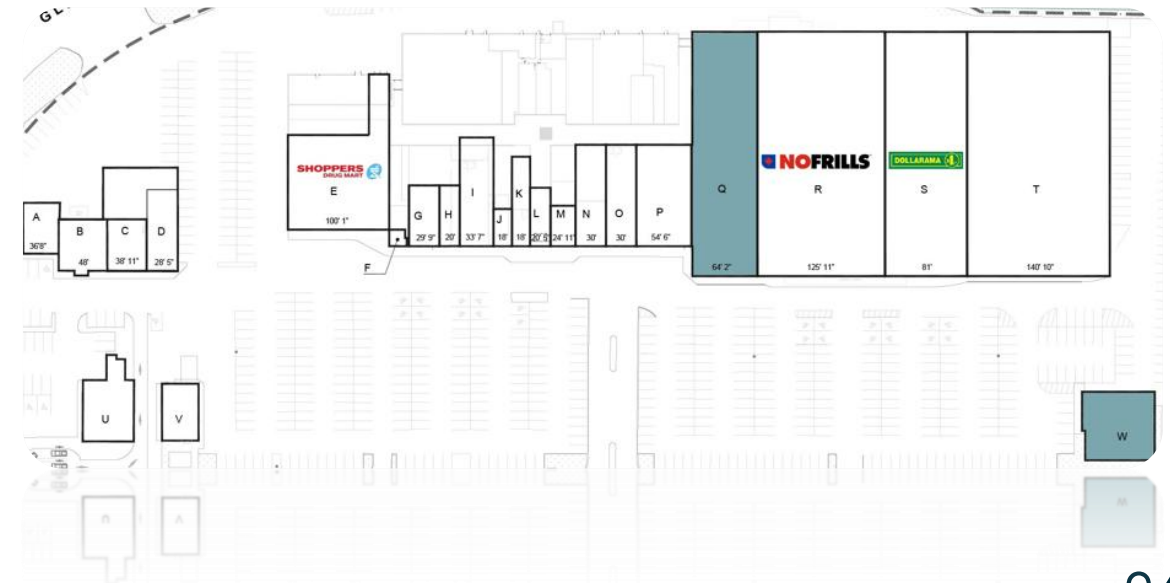



Timiskaming Plaza

883303 Hwy 65, RR#2, New Liskeard ON

FPI
plaza
REIT



- Future Development / À Venir:
 - Unit / Unité M – TBD sf/pc

- Anchor Tenants / Majeurs:
 - Food Basics
 - Shoppers Drug Mart



Contact:
Sacha Singh – (514) 476-8833
Sacha.singh@plaza.ca

[Flyer / Brochure](#)



Northern Avenue Plaza

248 Northern Ave E, Sault Ste Marie ON

FPI
plaza
REIT



- Open Units / Disponibilités:
 - Unit / Unité F – 600 sf/pc
 - Unit / Unité G – 1,257 sf/pc
 - Unit / Unité H – 1,617 sf/pc

- Anchor Tenants / Majeurs:
 - Metro, Winners/Home Sense
 - Princess Auto

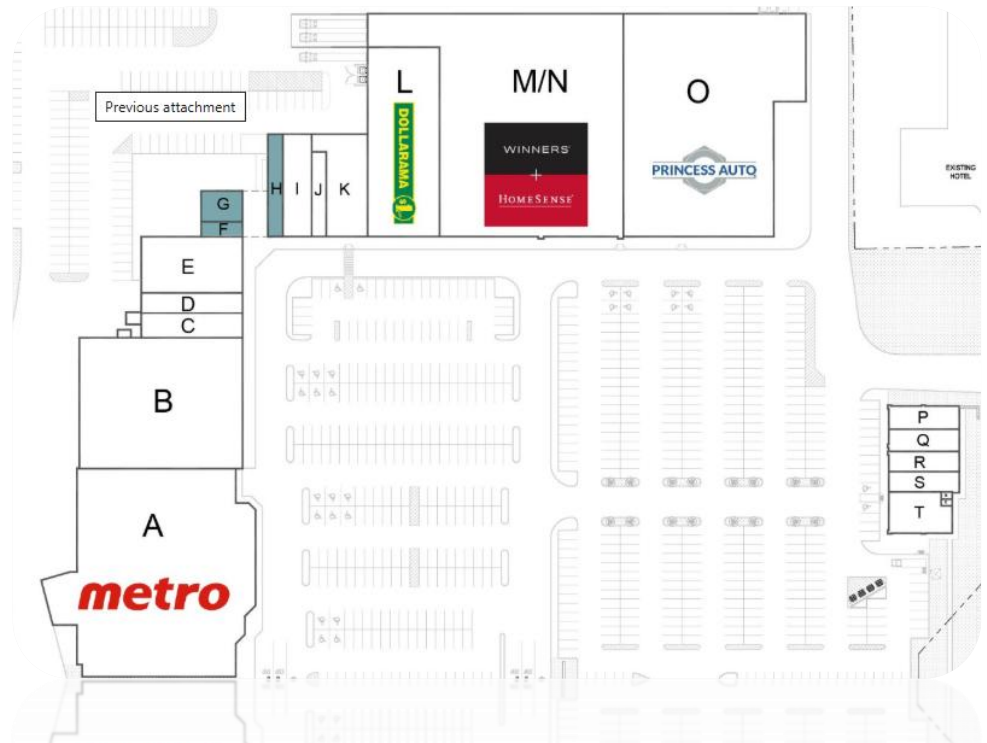

Contact:
 Sacha Singh – (514) 476-8833
Sacha.singh@plaza.ca

Flyer / Brochure



Niagara St & Quaker Rd Plaza

968 Niagara St, Welland ON

Tenants have taken delivery as of April 2026.

Les locataires ont pris livraison des locaux en avril 2026.

FPI
plaza
REIT

- Open Units / Disponibilités:
 - Unit / Unité C – 9,914 sf/pc
 - Unit / Unité D – 5,200 sf/pc
 - Units / Unités G – 1,720 sf/pc
 - Unit / Unité J – 1,500 sf/pc
 - Unit / Unité K – 1,300 sf/pc
 - Unit / Unité L – 1855 sf/pc
 - Unit / Unité N – 1,538 sf/pc
 - Unit / Unité Q – 1,255 sf/pc

- Anchor Tenants / Majeurs:
 - Longo's, Dollarama



Contact:
Sacha Singh – (514) 476-8833
Sacha.singh@plaza.ca

[Flyer / Brochure](#)

Québec

AVAILABLE OPPORTUNITIES
DISPONIBILITÉS





Plaza Charles-A-Cadieux

65 route du Président-Kennedy, Lévis QC



- Open Units / Disponibilités:
 - Unit / Unité J – 1,815 sf/pc

- Anchor Tenants / Majeurs:
 - Michaels
 - Bulk Barn



Contact:
Sacha Singh – (514) 476-8833
Sacha.singh@plaza.ca

[Flyer / Brochure](#)

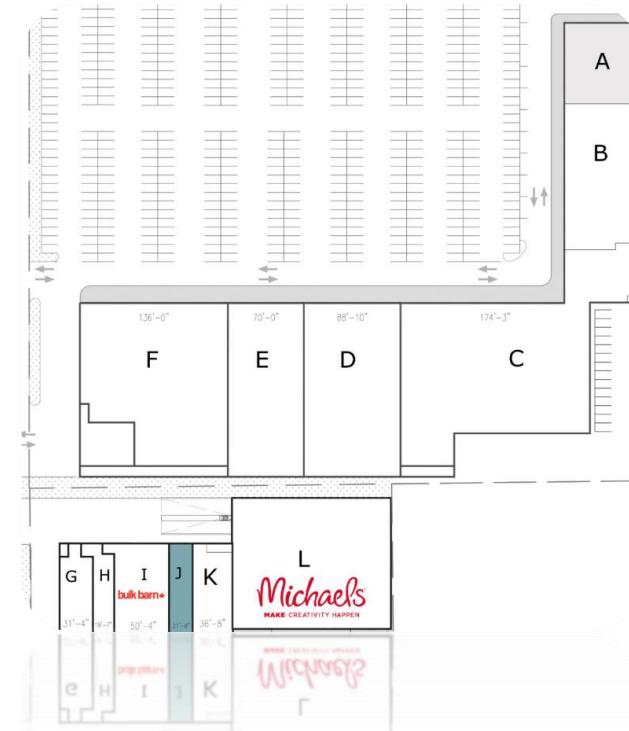



Plaza boulevard Royal

1702 41^e rue, Shawinigan QC



- **Open Units / Disponibilités:**

- Unit / Unité N – 13,625 sf/pc
(Office Space – Divisible Available Summer 2027 / Espace de bureau – divisible disponible à l'été 2027)

- **Anchor Tenants / Majeurs:**

- Rossy
- Dollarama

Contact:
 Sacha Singh – (514) 476-8833
Sacha.singh@plaza.ca
[Flyer / Brochure](#)

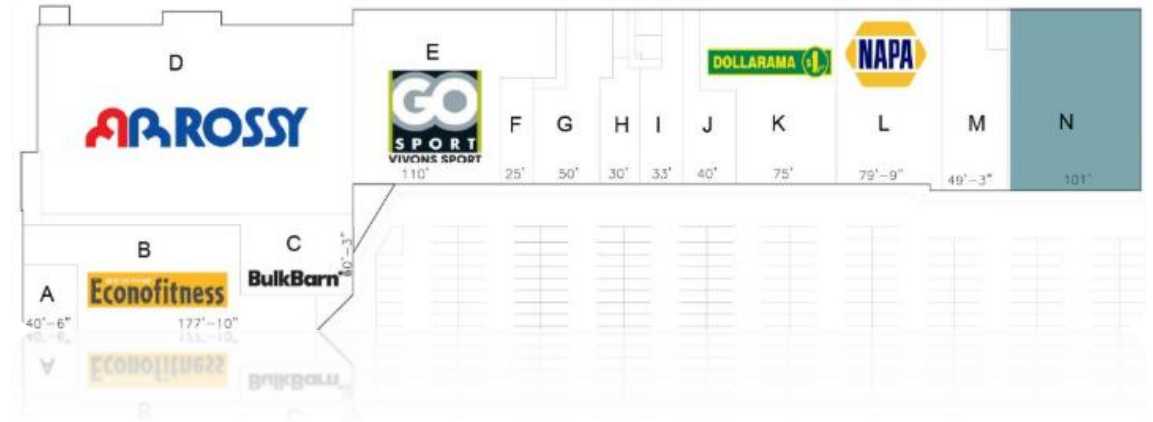



Les galeries Montmagny

81 et 101 boulevard Taché, Montmagny QC

FPI
plaza
REIT



- Open Units / Disponibilités:
 - Unit / Unité E – 500 sf/pc
 - Unit / Unité F – 738 sf/pc
 - Unit / Unité H – 1,654 sf/pc
 - Unit / Unité L – 910 sf/pc
 - Unit / Unité O à Q – 4,458 sf/pc
 - Unit / Unité T – 1,310 sf/pc
 - Unit / Unité V et W – 1,000 sf/pc
 - Unit / Unité Y – 750 sf/pc

Contact:
Sacha Singh – (514) 476-8833
Sacha.singh@plaza.ca

[Flyer / Brochure](#)

- Anchor Tenants / Majeurs:
 - Maxi
 - Dollarama
 - Sports Experts

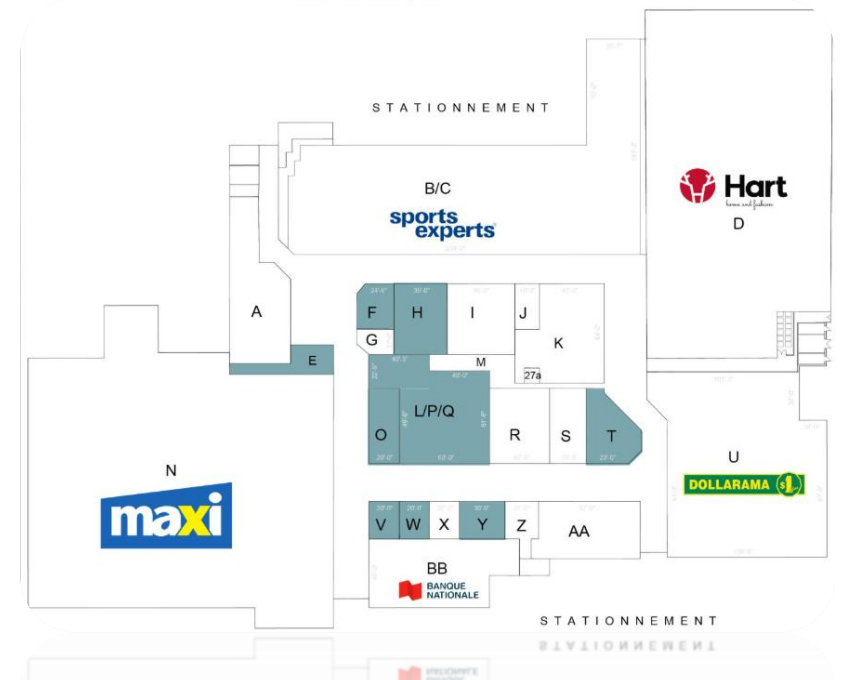



Les promenades du cuivre

Rue Terminus ouest, Rouyn-Noranda QC

FPI
plaza
REIT



- Open Units / Disponibilités:
 - Unit / Unité F – 1,248 sf/pc
 - Unit / Unité G – 924 sf/pc
 - Unit / Unité H – 1,313 sf/pc
 - Unit / Unité J – 832 sf/pc
 - Unit / Unité AA – 1,196 sf/pc
 - Unit / Unité HH – 1,433 sf/pc
 - Unit / Unité II – 2,213 sf / pc
 - Unit / Unité MM – 2,767 sf/pc
 - Kiosk / Kiosque NN

- Anchor Tenants / Majeurs:
 - Pharmaprix
 - Winners
 - Bureau en gros

Contact:
Sacha Singh – (514) 476-8833
Sacha.singh@plaza.ca

Flyer / Brochure

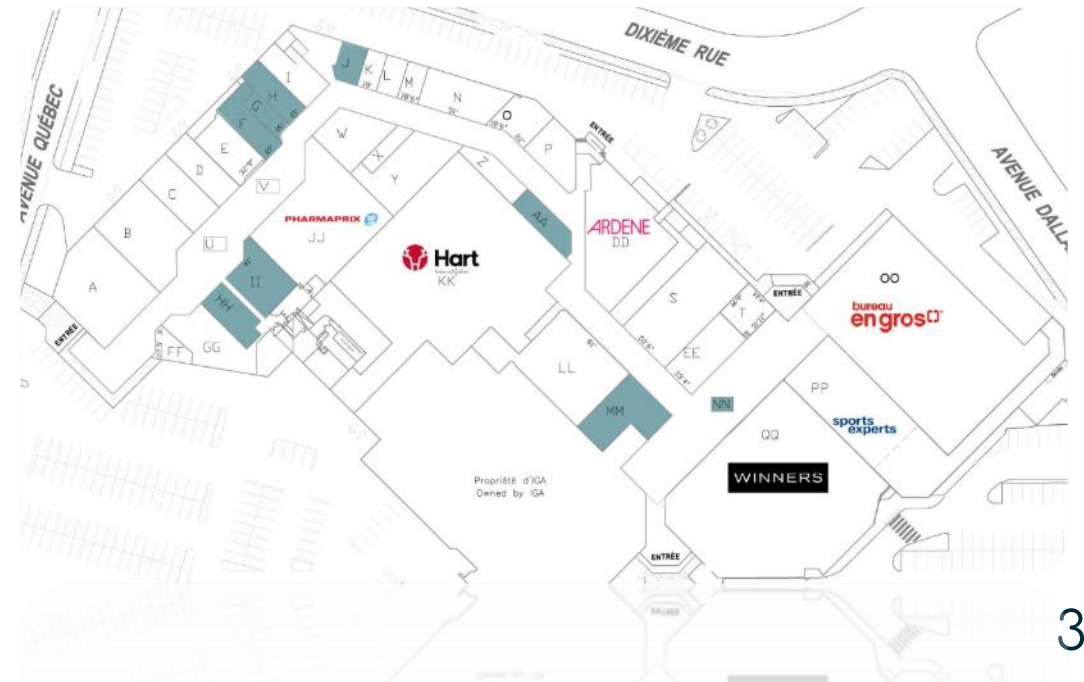

Plaza BBRF

5050 boulevard Bourque, Sherbrooke QC

FPI
plaza
REIT



- **Open Units / Disponibilités:**
 - Unit / Unité B – 4,000 sf/pc

Can be divided and can be made to accommodate drive-through service and terrace. / Divisible avec possibilité de service-au-volant et terrasse.

- **Anchor Tenants / Majeurs:**
 - Pharmaprix

Contact:
Sacha Singh – (514) 476-8833
Sacha.singh@plaza.ca

[Flyer / Brochure](#)

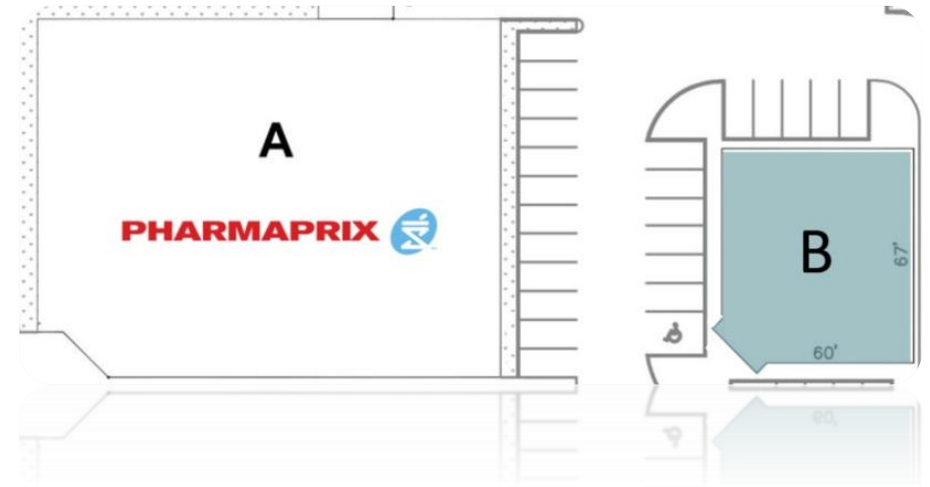



Plaza de l'ouest

4857 boulevard Bourque, Sherbrooke QC

FPI
plaza
REIT



- Future Development / À Venir:
 - Unit / Unité W – 3,600 sf/pc

- Anchor Tenants / Majeurs:
 - Metro, Brunet, Dollarama



Contact:
Sacha Singh – (514) 476-8833
Sacha.singh@plaza.ca

Flyer / Brochure





Les promenades St-François

600 Montée du Moulin, Laval QC

FPI
plaza
REIT



- Open Units / Disponibilités:
 - Unit / Unité H – 1,095 sf/pc

- Anchor Tenants / Majeurs:
 - Rona, Dollarama
 - Desjardins, Jean Coutu

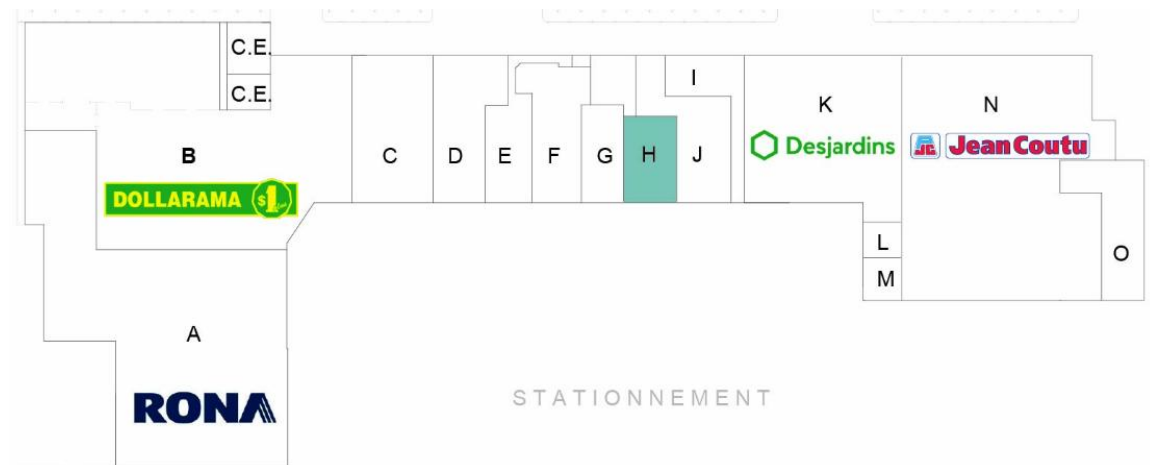

Contact:
Sacha Singh – (514) 476-8833
Sacha.singh@plaza.ca

[Flyer / Brochure](#)

Meet the TEAM!



Mathieu Bordeleau

Mathieu.bordeleau@plaza.ca



Brian Wall

Brian.wall@plaza.ca



Tim Bourque

Tim.bourque@plaza.ca



Sacha Singh

Sacha.singh@plaza.ca