



This project is strategically located in the heart of the St. Peter Avenue commercial area.







GLA approx. 23,000 sq.ft

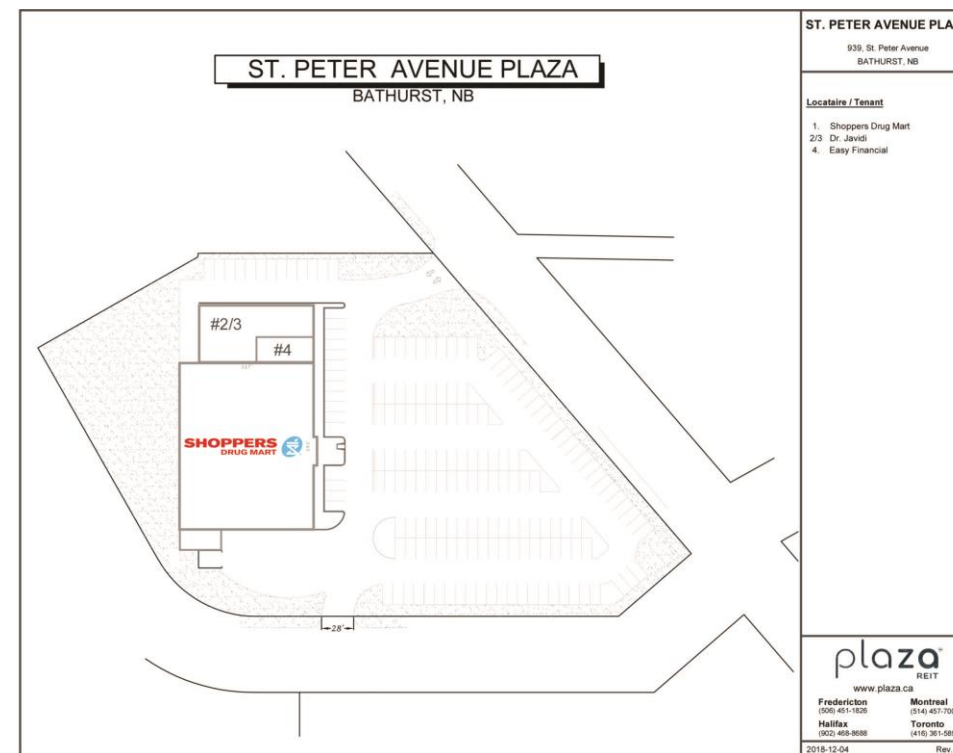

3  
Stores / Services



	0-5 minute drive	0-10 minute drive	0-15 minute drive
 Total Population	3,849	11,845	19,117
 Daytime population	3,798	8,270	10,280
 Average Household Income	\$59,347	\$72,286	\$76,674
 Median Age	52.9	54.0	53.0

\*Data Source: 2020 Environics Analytics

