

# ST. ANNE STREET PLAZA BATHURST, NB



**Address** 930 St. Anne Street, Bathurst, New Brunswick

**Area** 25,680 sq. ft.

**Parking Spaces** 180

**Retailers** Dollarama, Reitmans, Payless Shoes and Easyhome

**Property Summary** The property is strategically located between the new Wal-Mart and Kent Stores.

**Address:**  
98 Main Street  
Fredericton, NB  
E3A 9N6



**Contact:**  
Brian Wall  
506-461-6456  
brian.wall@plaza.ca

# ST. ANNE STREET PLAZA

Bathurst, N.B.

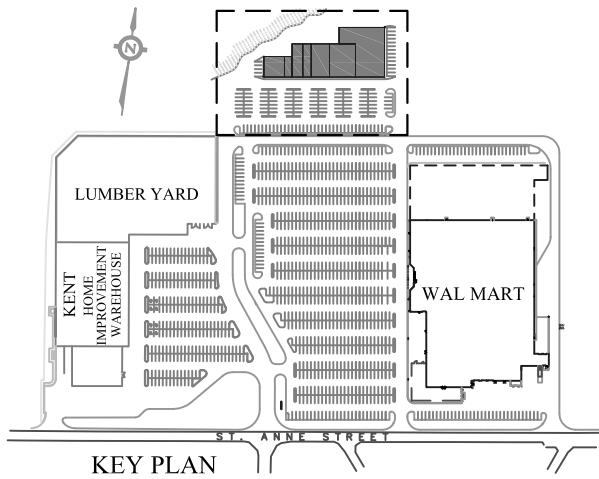

## ST. ANNE STREET PLAZA BATHURST, N.B.

Locataire / Tenant	p.c./sq.ft.
1. Dollarama	9,800
2. Reitmans	5,000
3. Easy Home	3,600
4. <b>Available</b>	<b>1,600</b>
5. Sally Beauty	1,500
6. <b>Available</b>	<b>900</b>
7. Payless Shoes	2,500

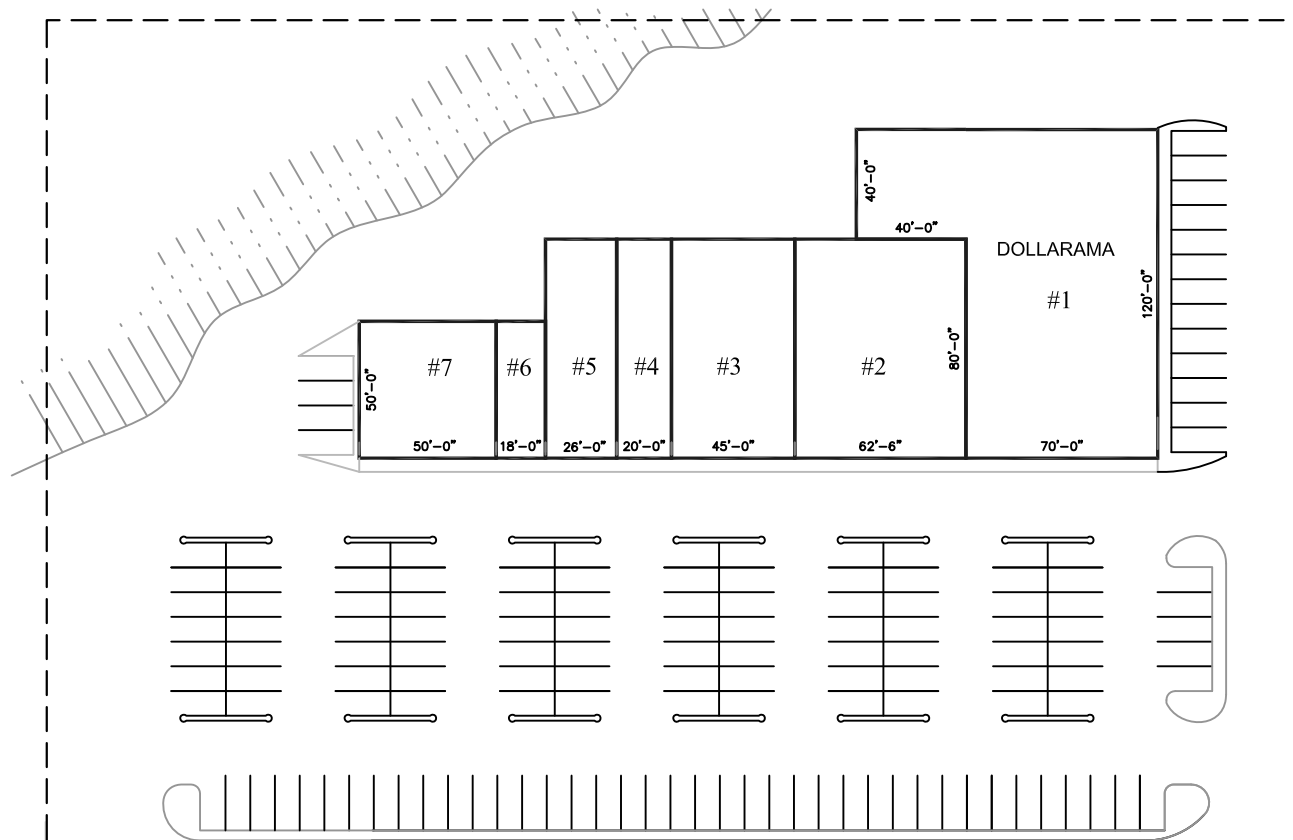

Fredericton  
(506) 451-1826  
Montreal  
(514) 457-7007  
Halifax  
(902) 468-8688  
Toronto  
(416) 361-5892

www.plaza.ca