

NORTHWEST CENTRE MONCTON, NB

Address 1380 – 1400 Mountain Road, Moncton, New Brunswick

Area 238,535 sq. ft.

Parking Spaces 1,500

Major Retailers Marshalls, Reitmans, Sportchek, Canadian Tire and Sobeys (retailer owned)

Property Summary The Northwest Centre is strategically located on Mountain Road in close proximity to the Wheeler Boulevard Power Centre (Costco, Kents, Loblaws, etc.), Wal-Mart, Winners, Best Buy and Home Depot.



Address:
98 Main Street
Fredericton, NB
E3A 9N6



Contact:
Brian Wall
506-461-6456
brian.wall@plaza.ca

NORTHWEST CENTRE

MONCTON, N.B.

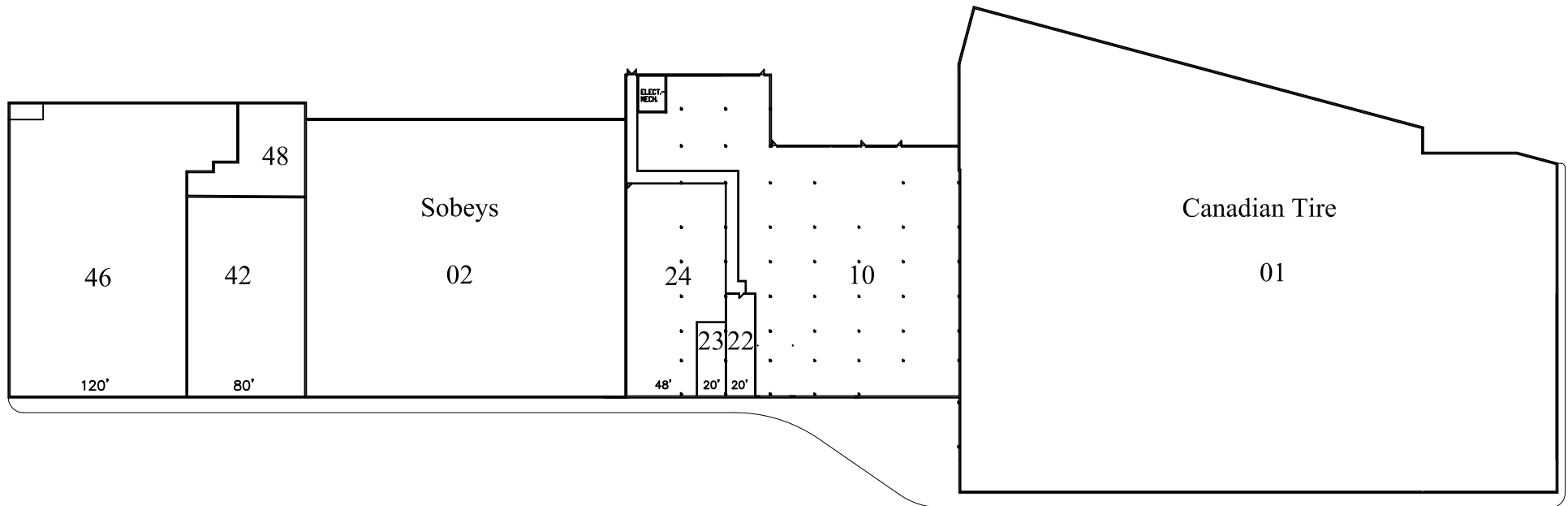

NORTHWEST CENTRE
 MONCTON, NEW BRUNSWICK
 1380 Mountain Road

<u>Locataire / Tenant</u>	<u>p.c./sq.ft.</u>
01 Canadian Tire	110,472
02 Sobeys	52,000
10 Marshalls	28,290

<u>Locataire / Tenant</u>	<u>p.c./sq.ft.</u>
22 Subway	1,400
23 H&R Block	1,000
24 Reitmans	6,000
42 Available/Disponible	10,566
46 Sport Chek	24,761
48 Available/Disponible	1,082



www.plaza.ca

Fredericton
 (506) 451-1826
 Montreal
 (514) 457-7007
 Halifax
 (902) 468-8688
 Toronto
 (416) 361-5892

NORTHWEST CENTRE

MONCTON, N.B.

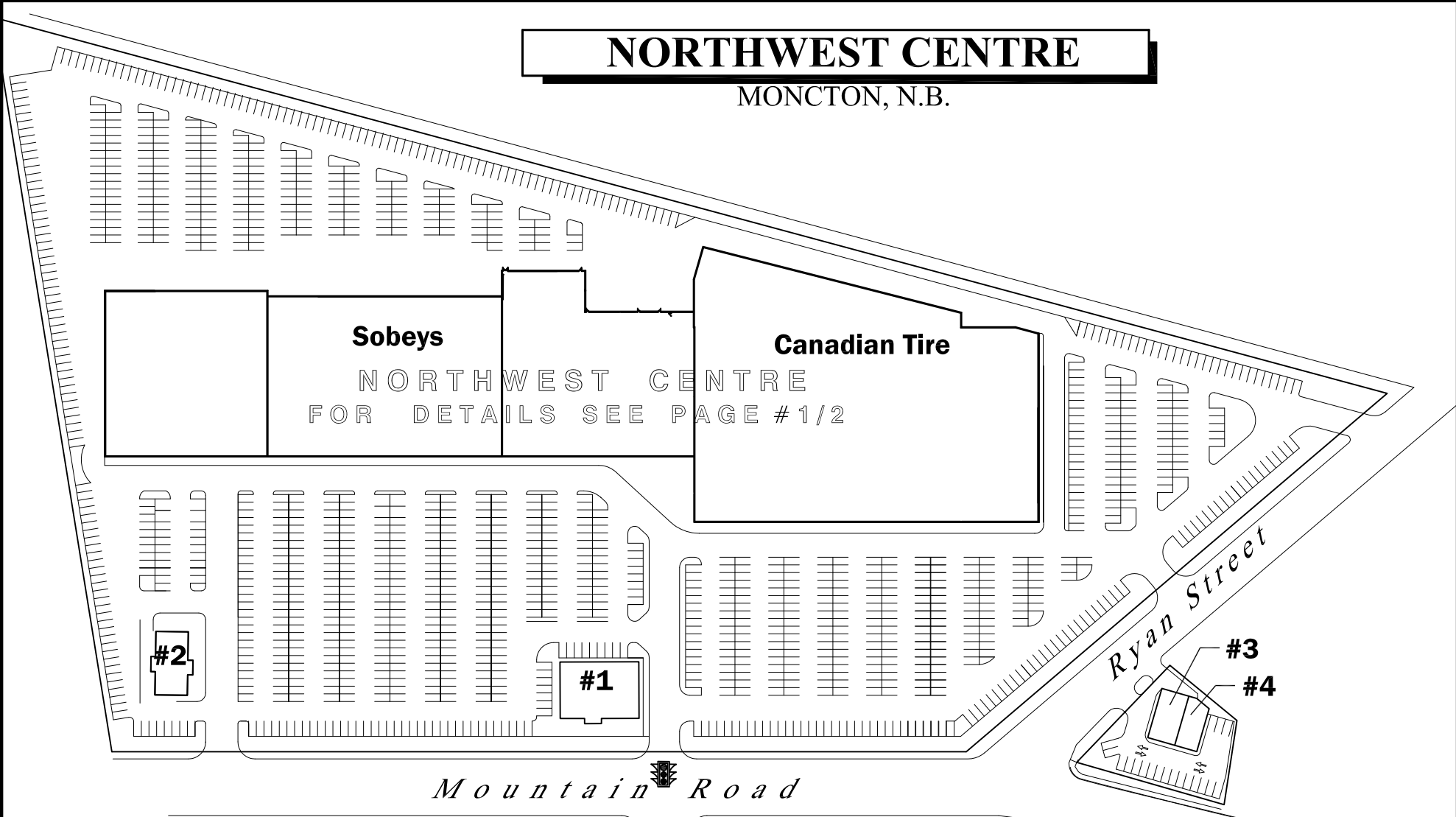

NORTHWEST CENTRE MONCTON, NEW BRUNSWICK 1380 Mountain Road		
<u>Locataire / Tenant</u>	<u>p.c./sq.ft.</u>	
Pad #1 Boston Pizza	6,350	
Pad #2 Dairy Queen	3,044	
Pad #3 Battery House	1,980	
Pad #4 Money Mart	1,555	



Fredericton
(506) 451-1826
Montreal
(514) 457-7007
Halifax
(902) 468-8688
Toronto
(416) 361-5892

www.plaza.ca