

MIRAMICHI POWER CENTRE PHASE I MIRAMICHI, NB

Address 98-102 Douglastown Boulevard, Miramichi,
New Brunswick

Area 39,361 sq. ft.

**Parking
Spaces** 380

**Major
Retailers** Staples, Mark's Work Wearhouse

**Property
Summary** This property is strategically located near the
new Miramichi Wal-Mart and is in close
proximity to: Canadian Tire, Sobeys and the
Northumberland Mall (the area's regional
mall).



Address:
98 Main Street
Fredericton, NB
E3A 9N6



Contact:
Brian Wall
506-461-6456
brian.wall@plaza.ca

MIRAMICHI POWER CENTRE

Phase -I-

Miramichi, N.B.

Miramichi Power Centre
98-102 Douglastown Boulevard
Miramichi, N.B.

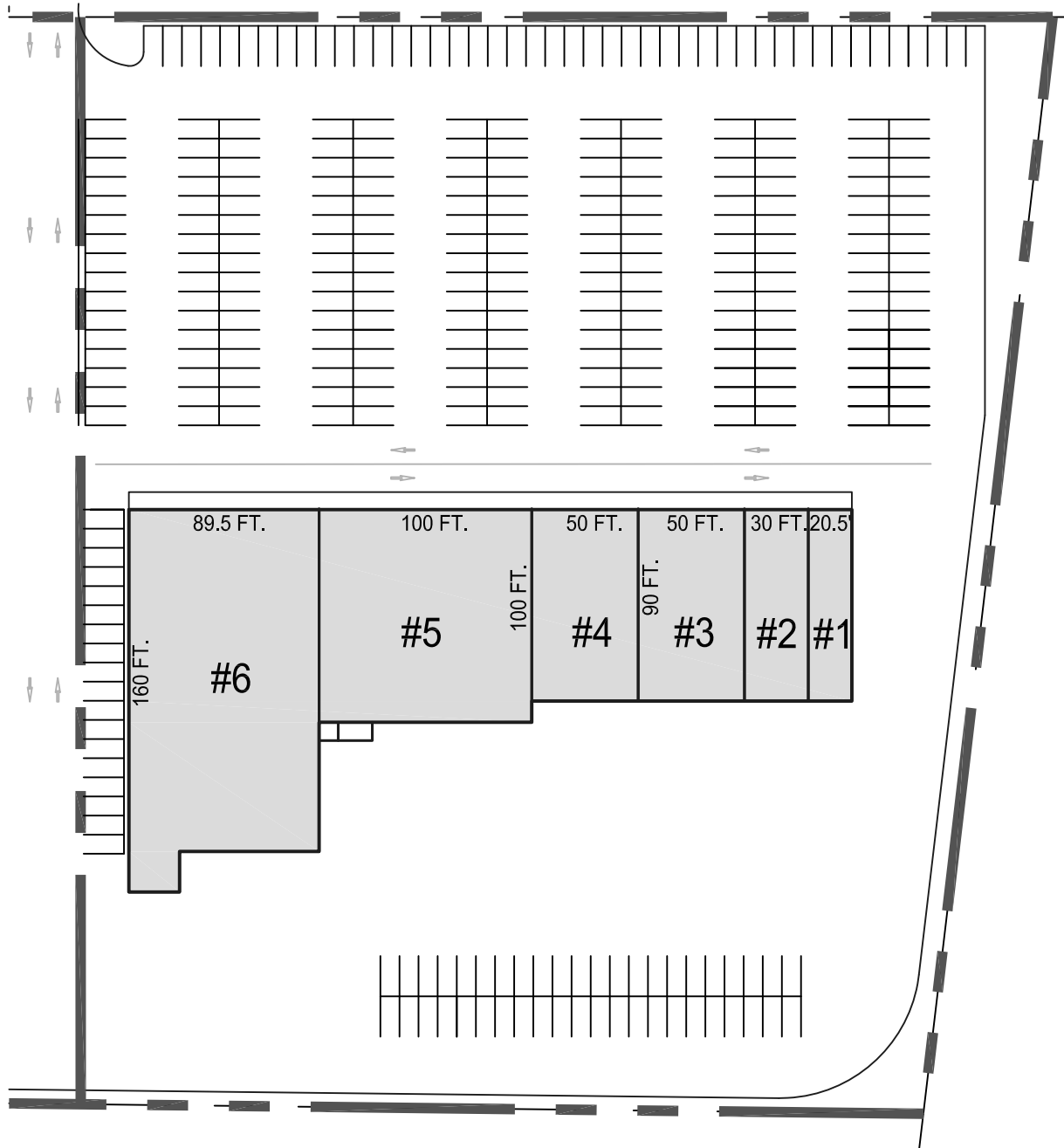

Locataire / Tenant **p.c./sq.ft.**

1. E.B. Games	1,800
2. The Source	2,712
3. Bulk Barn	4,481
4. Reitman's	4,469
5. Mark's Work Warehouse	10,010
6. Staples	14,607



Fredericton
(506) 451-1826
Montreal
(514) 457-7007
Halifax
(902) 468-8688
Toronto
(416) 361-5892

www.plaza.ca