

# MIRAMICHI POWER CENTRE PHASE II MIRAMICHI, NB

**Address** 99-100 Douglastown Boulevard, Miramichi,  
New Brunswick, E1V 0A3

**Area** 22,716 sq. ft.

**Parking  
Spaces** 172

**Major  
Retailers** Dollarama, Boston Pizza, A & W

**Property  
Summary** This property is strategically located near the  
new Miramichi Wal-Mart and is in close  
proximity to: Canadian Tire, Sobeys and the  
Northumberland Mall (the area's regional  
mall).



**Address:**  
98 Main Street  
Fredericton, NB  
E3A 9N6



**Contact:**  
Brian Wall  
506-461-6456  
brian.wall@plaza.ca

# MIRAMICHI POWER CENTRE

Phase -II-

Miramichi, N.B.

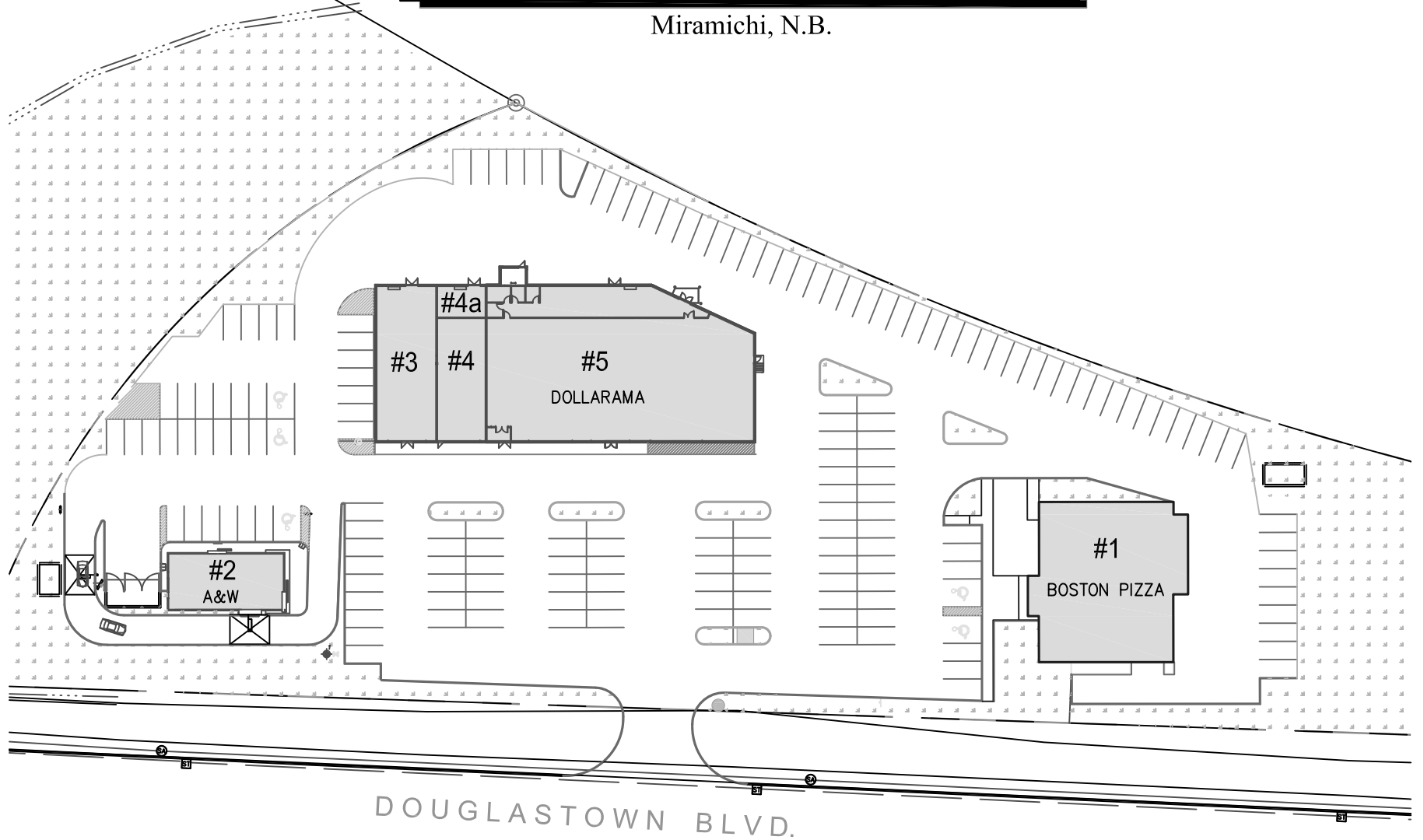

<b>Locataire / Tenant</b>	<b>p.c./sq.ft.</b>
1. Boston Pizza	5 600
2. A&W	2 400
3. Payless Shoes	2 439
4. Sally Beauty	1 620
4a. Available	380
5. Dollarama	10,077

**Miramichi Power Centre**  
99-100 Douglastown Boulevard  
Miramichi, N.B.



www.plaza.ca

Fredericton  
(506) 451-1826  
Montreal  
(514) 457-7007  
Halifax  
(902) 468-8688  
Toronto  
(416) 361-5892