

# FHS PLAZA FREDERICTON, NB

**Address** 1055 Prospect Street, Fredericton, New Brunswick

**Area** 24,466 sq. ft.

**Parking Spaces** 105

**Major Retailers** Cleve's Sports, Bulk Barn

**Property Summary** FHS Plaza is centrally located in the heart of Fredericton's commercial area.

This commercial area includes the Fredericton Mall (246 000 sq. ft. ); Smythe Street Plaza (176 000 sq. ft.); and Regent Mall (446 000 sq. ft.).



**Address:**  
98 Main Street  
Fredericton, NB  
E3A 9N6



**Contact:**  
Brian Wall  
506-461-6456  
brian.wall@plaza.ca

# F.H.S. PLAZA

FREDERICTON, N.B.

F.H.S. PLAZA  
1055 Prospect Street  
FREDERICTON, N.B.

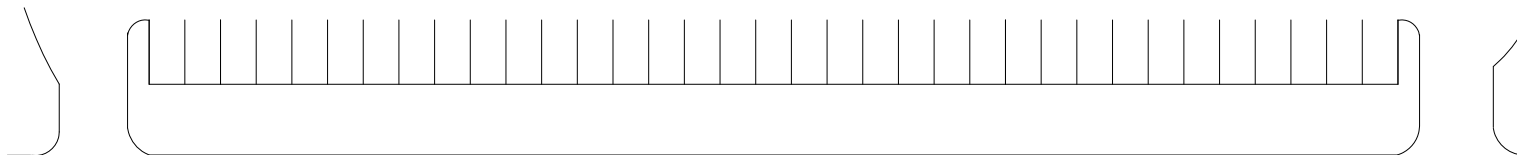
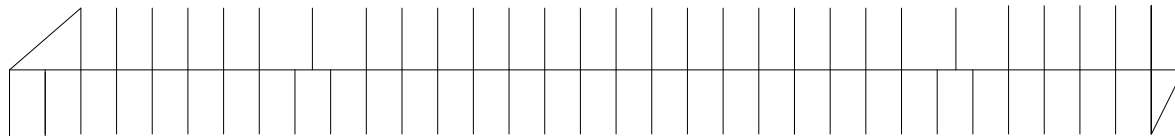
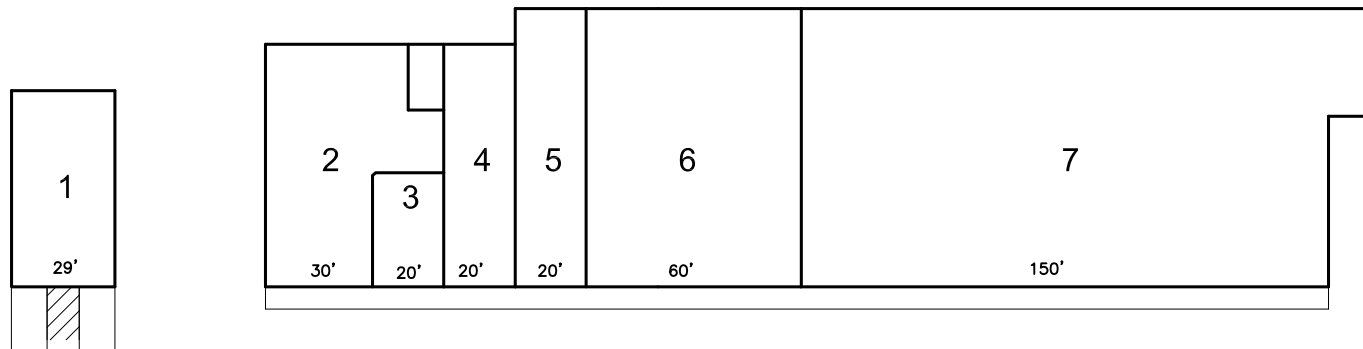

PROSPECT STREET

<u>Locataire / Tenant</u>	<u>p.c./sq.ft.</u>
1. Subway	1,600
2. Blue Cross	2,546
3. Harvey's Travel Ltd.	644
4. Second to none Barbershop	1,350
5. Fairstone	1,560
6. Bulk Barn	4,766
7. Cleve's Sports	12,000



www.plaza.ca

Fredericton  
(506) 451-1826  
Montreal  
(514) 457-7007  
Halifax  
(902) 468-8688  
Toronto  
(416) 361-5892