

EXHIBITION PLAZA

SAINT JOHN, NB

Address 147-175 McAllister Drive, Saint John, New Brunswick

Area 74,800 sq. ft.

Parking Spaces 620

Major Retailers Cineplex Cinemas, Mark's Work Wearhouse, Pennington's

Property Summary Exhibition Plaza features an excellent location on the corner of Westmorland Road and McAllister Drive in the centre of the McAllister Drive commercial area, the dominant retail and shopping area of Saint John.

Other retail in the immediate market includes: Parkway Mall (216,000 sq. ft. enclosed); McAllister Place (475,000 sq. ft. enclosed); and Westmorland Centre (includes Wal-Mart, Canadian Tire and Kent Stores).



Address:
98 Main Street
Fredericton, NB
E3A 9N6



Contact:
Brian Wall
506-461-6456
brian.wall@plaza.ca

EXHIBITION PLAZA

SAINT JOHN, N.B.

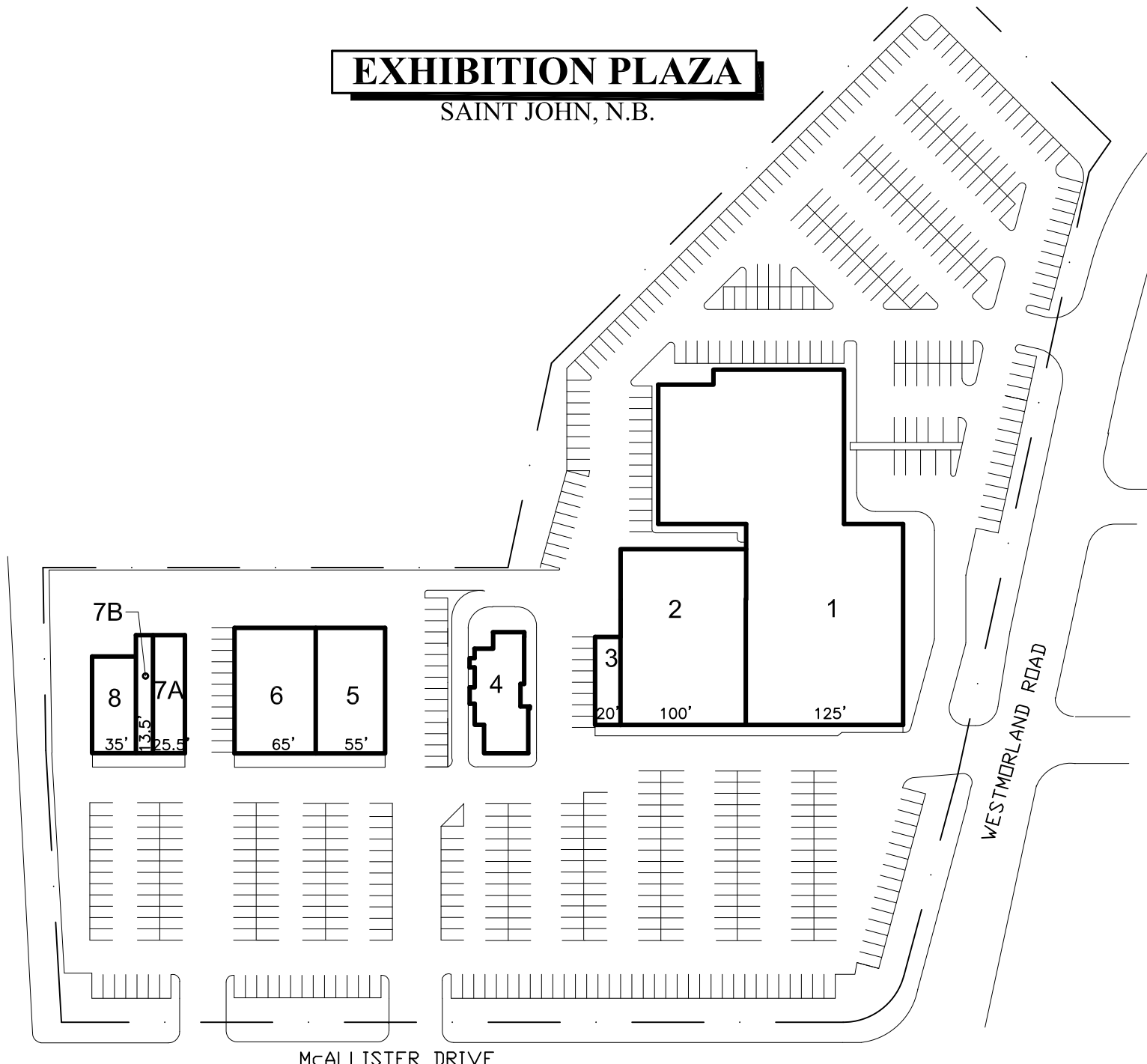

EXHIBITION PLAZA

147-175 McAllister Drive
SAINT JOHN, N.B.

<u>Locataire / Tenant</u>	<u>p.c./sq.ft.</u>
1. Cineplex Entertainment	37,738
2. Mark's Work Wearhouse	14,000
3. Subway	1,412
4. Wendy's	4,100
5. Pennington's	5,507
6. Bulk Barn	6,518
7A. Hakim Optical	2,110
7B. H & R Block	1,260
8. Tim Horton	2,700



Fredericton
(506) 451-1826
Montreal
(514) 457-7007
Halifax
(902) 468-8688
Toronto
(416) 361-5892

www.plaza.ca