

# COMMERCIAL STREET PLAZA PHASE I & II NEW MINAS, NS

**Address** 9275 – 9293 Commercial Street, New Minas,  
Nova Scotia, B4N 3G2

**Area** 23,762 sq. ft.

**Parking  
Spaces** 100

**Major  
Retailers** Swiss Chalet, Harvey's, Penningtons,  
SleepCountry

**Property  
Summary** The Commercial Street Plaza is centrally located  
on Commercial Street, the main artery and  
central retail area of New Minas.

The property is located across the street from  
the County Fair Mall, a 305 000 sq. ft. enclosed  
shopping centre anchored by Targets, Sears,  
Sobeys and Canadian Tire near the Wal-Mart  
and Staples stores.



**Address:**  
998 Parkland Drive, Suite 201  
Halifax, NS  
B3M 0A6



**Contact:**  
Jim Pushie  
902-468-8688  
jim.pushie@plaza.ca

# COMMERCIAL STREET PLAZA

NEW MINAS, N.S.

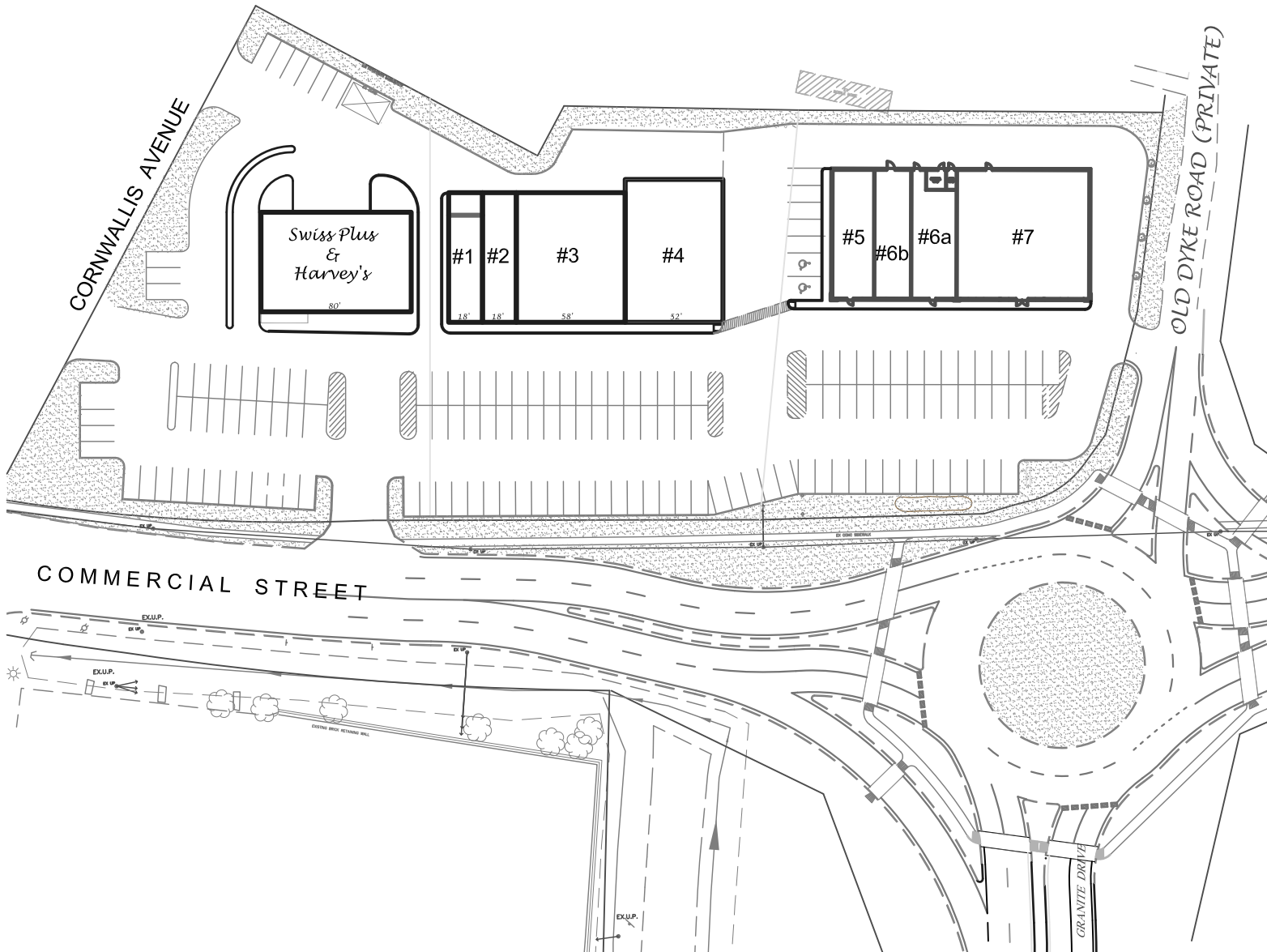

COMMERCIAL STREET  
PLAZA  
Commercial Street  
NEW MINAS, N.S.

## Phase I

<u>Tenant</u>	<u>sq.ft.</u>
1. Money Direct	1,100
2. Maxwell Shoes	1,262
3. Pennington's	4,000
4. Easyhome	4,000
Swiss Plus & Harvey's	5,000

## Phase II

<u>Tenant</u>	<u>sq.ft.</u>
5. Pita Pit	1,500
6a. Available	1,508
6b. Easy Financial	1,480
7. Sleep Country	5,000



www.plaza.ca

Fredericton  
(506) 451-1826  
Montreal  
(514) 457-7007  
Halifax  
(902) 468-8688  
Toronto  
(416) 361-5892