

BEDFORD COMMONS PHASE II BEDFORD, NS.

Address 181 Damascus Road, Bedford, Nova Scotia

Area 105,157 sq. ft.

Parking Spaces 492

Major Retailers Winner's, Staples, Sportchek, Petsmart

Property Summary This property is situated just off the highway in a growing retail area including Wal-Mart, Canadian Tire and Bedford Commons Phase I.



Address:
998 Parkland Drive, Suite 201
Halifax, NS
B3M 0A6



Contact:
Verna Bulley
902-468-8688
verna.bulley@plaza.ca

BEDFORD COMMONS PLAZA - Ph. II

BEDFORD, N.S.

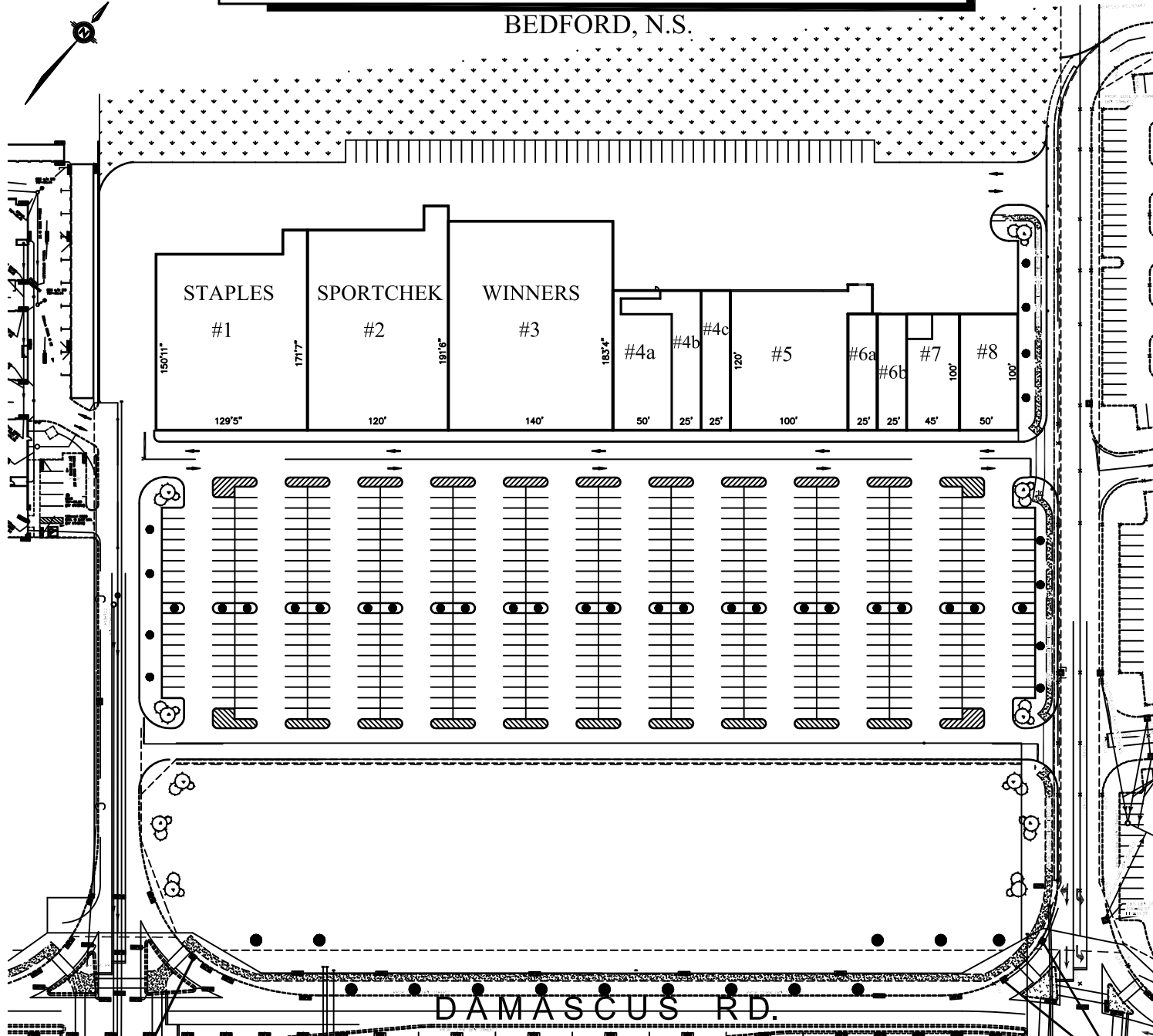

BEDFORD COMMONS PLAZA - Ph. II

Bedford, N.S.

<u>Tenant</u>	<u>sq.ft.</u>
1. Staples	19,988
2. Sportcheck	20,987
3. Winners	25,696
4a. Ricki's	5,316
4b. Floors etc.	3,647
4c. Available	3,000
5. Pet Smart	12,533
6a. Available	2,500
6b. Allstate	2,500
7. Wicker Emporium	4,000
8. Penningtons	4,986



Fredericton
(506) 451-1826
Montreal
(514) 457-7007
Halifax
(902) 468-8688
Toronto
(416) 361-5892